

## IN OUT FLY WOOD

Sistem de uși glisante fără șină inferioară

Set role

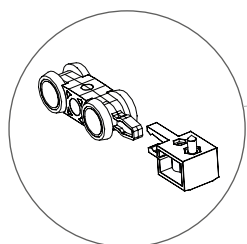

SAS 430.100

Set de 1 rolă și 1 opritor. (1 set pentru 1 parte; setul trebuie combinat cu alt set de role sau cu un amortizor).

Capăt șină superioară

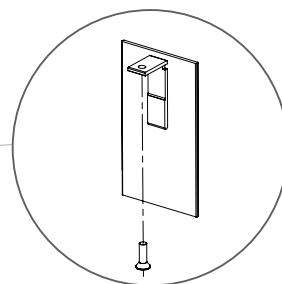

SAS 140.180

(OPȚIONAL)

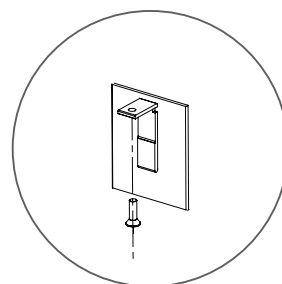

SAS 140.155

(OPȚIONAL)

Set accesorii uși

Incluce conectori, șuruburi și pinul de ghidare.

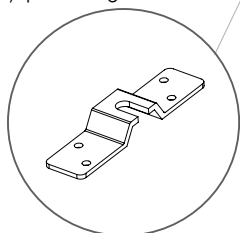

SAS 230.241

Șină pentru pinul de ghidare

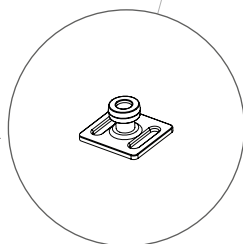

SAS 210.100

Profil plastic de acoperire

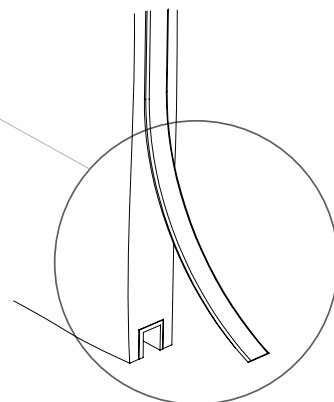

SAS 520.300.11

### Cale de rulare

SAS 210.161

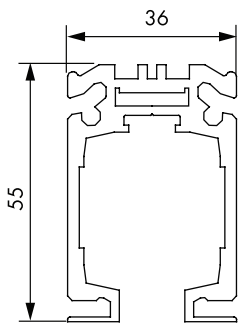

### Profil montaj perete

SAS 110.110

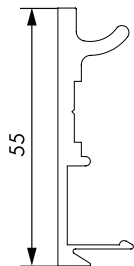

### Profil de acoperire

SAS 110.100

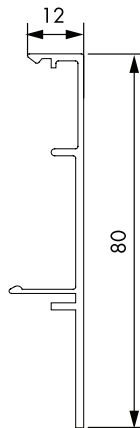

### Șină de ghidare

SAS 210.100

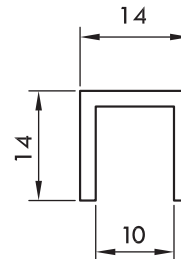

### Amortizor

Role integrate și un activator. (1 set pentru 1 parte)

SAS 430.110

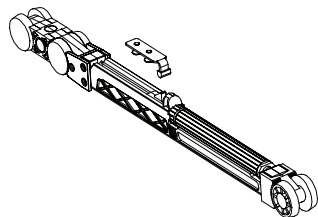

Lățime ușă

Nr. amortizori

< 700 mm	0
701-900 mm	1
900 mm <	2

### Mâner "SQUARE 160" - Opțional

Necesită frezare pe ușă.

SAS 590.450

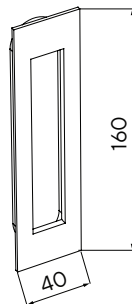

### Mâner "LINEA" - Opțional

SAS 190.470

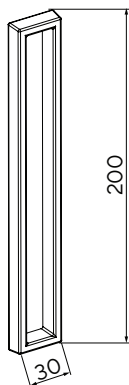

Se fixează cu bandă bi-adezivă (inclusă). Nu este nevoie de găurire sau frezare pe suprafața ușii. Articolul include 1 bucată.

## EXEMPLE MONTAJ

### 1 UȘĂ

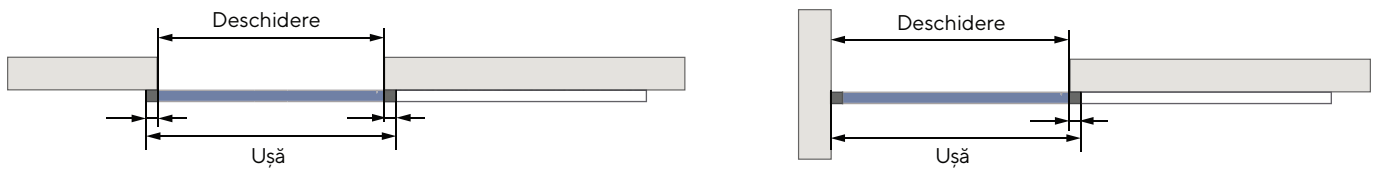

### 2 UȘI

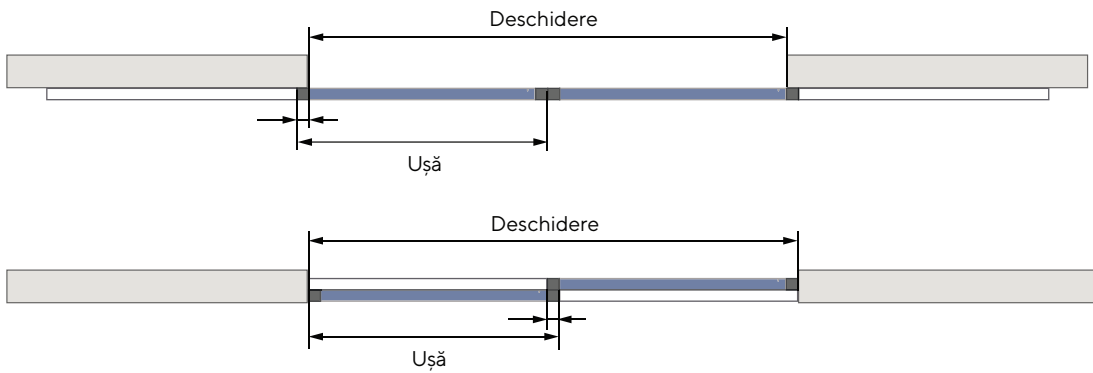

### 3 UȘI

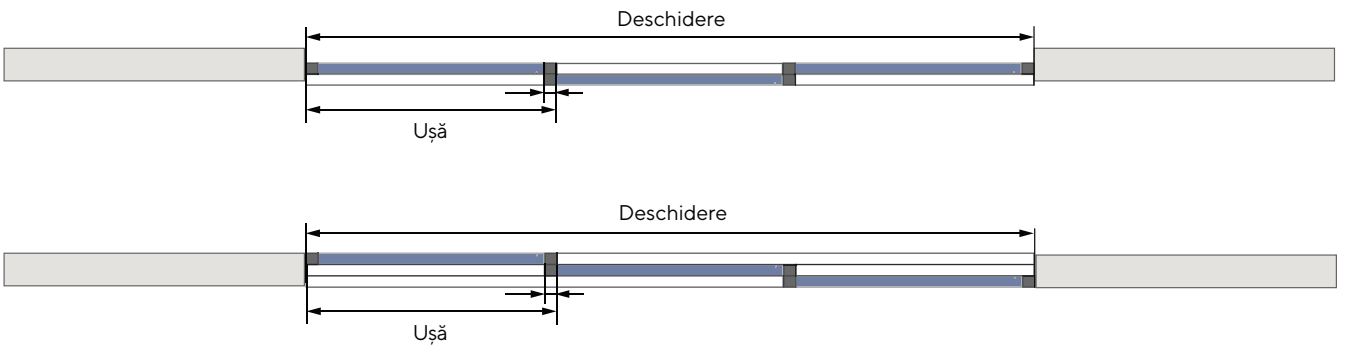

**Lemn cu grosimea de 25 mm**

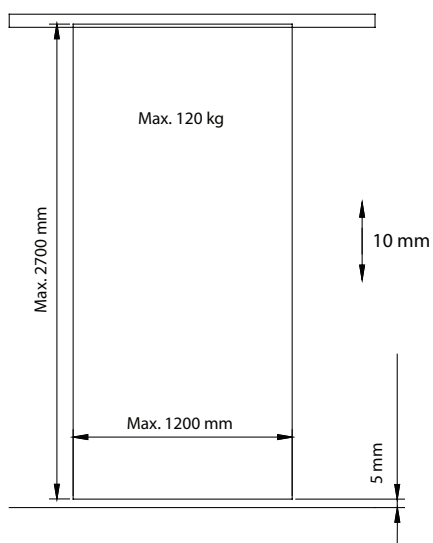
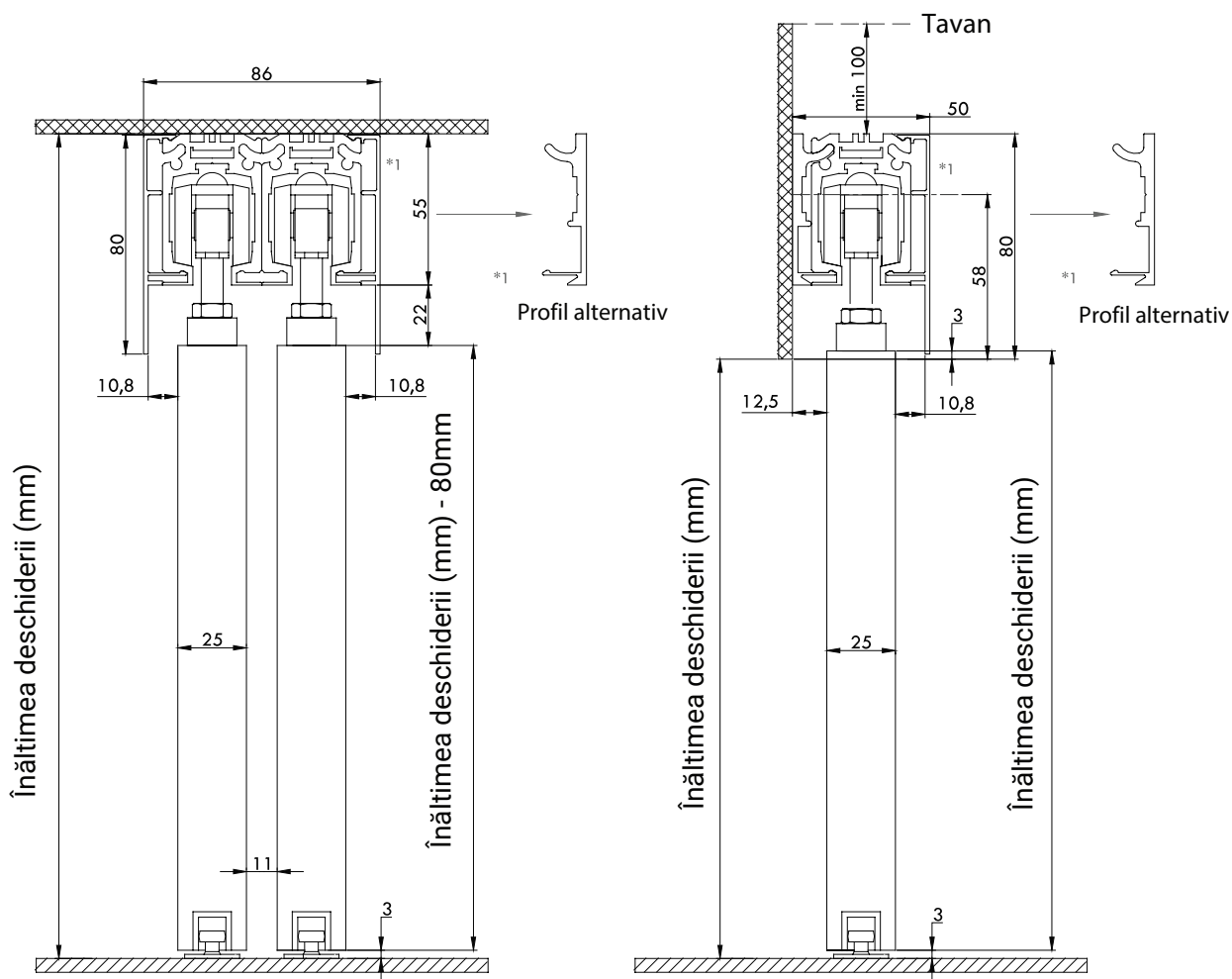

Reglarea pe înălțime a ușii

cu soft close: 10 mm  
fără soft close: 10 mm

Deschiderea ușii= Lățimea ușii x 2 - 10 mm

**Lemn cu grosimea de 40 mm**

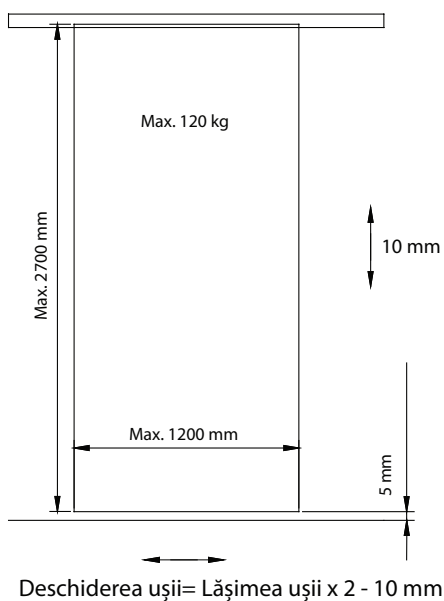
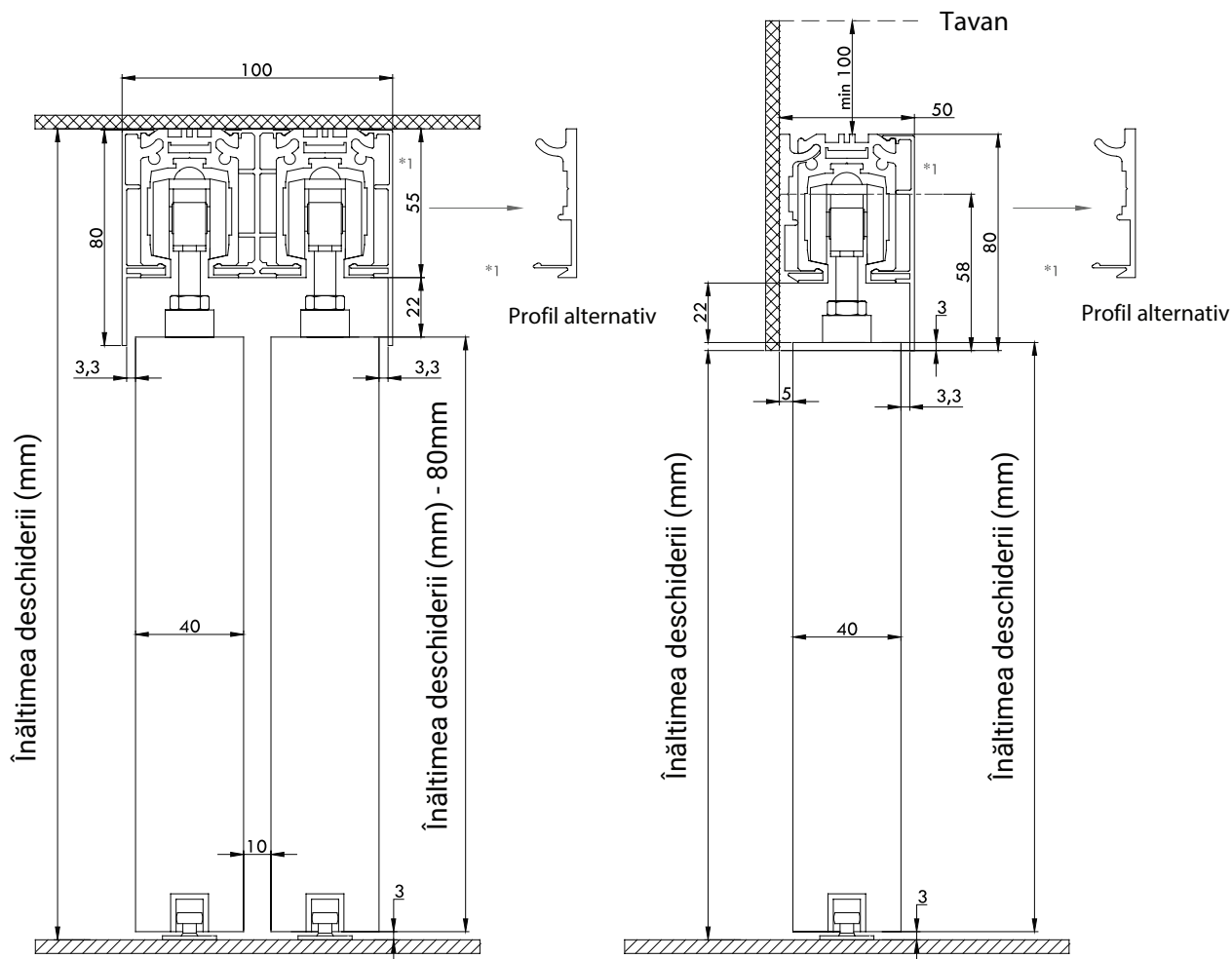

Reglarea pe înălțime a ușii

- cu soft close: 10 mm
- fară soft close: 10 mm