

Art. 004 PRO

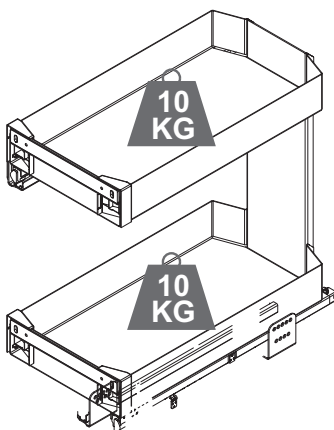

Componente

A. Coș

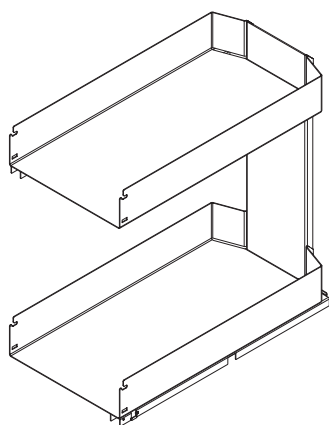

Dimensiuni corp

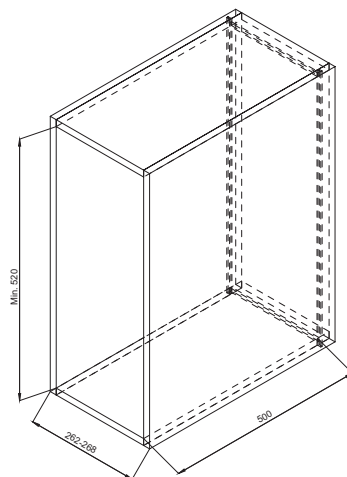

B. Glisiere

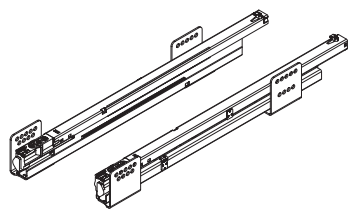

C. Cleme prindere ușă

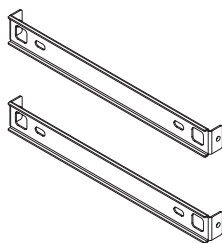

D. Plăcuțe

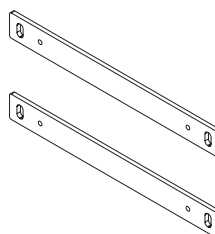

E. Distanțieri 2mm

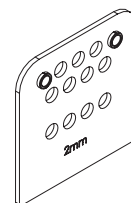

F. Capace de acoperire

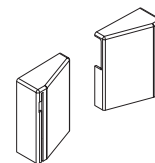

Montaj

Pentru grosimi de 18-19mm puteți începe direct montajul glisierelor, fără a mai fi necesară montarea distanțierilor, destinați grosimilor de 16-17mm.

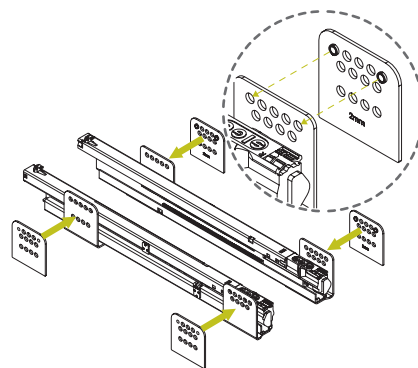
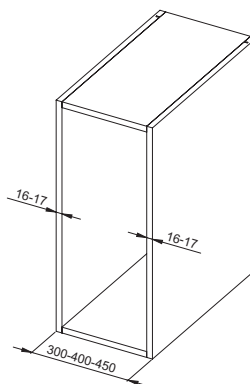
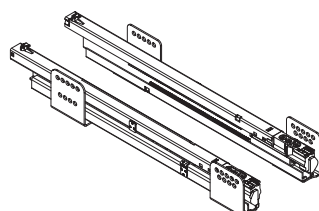
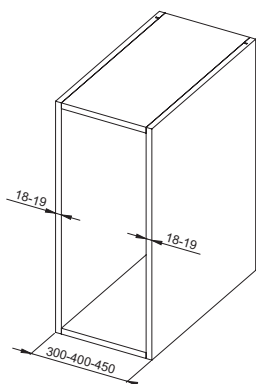

Poziționați glisierile B respectând cotele și fixați-le cu șuruburi pe lateralele corpului.

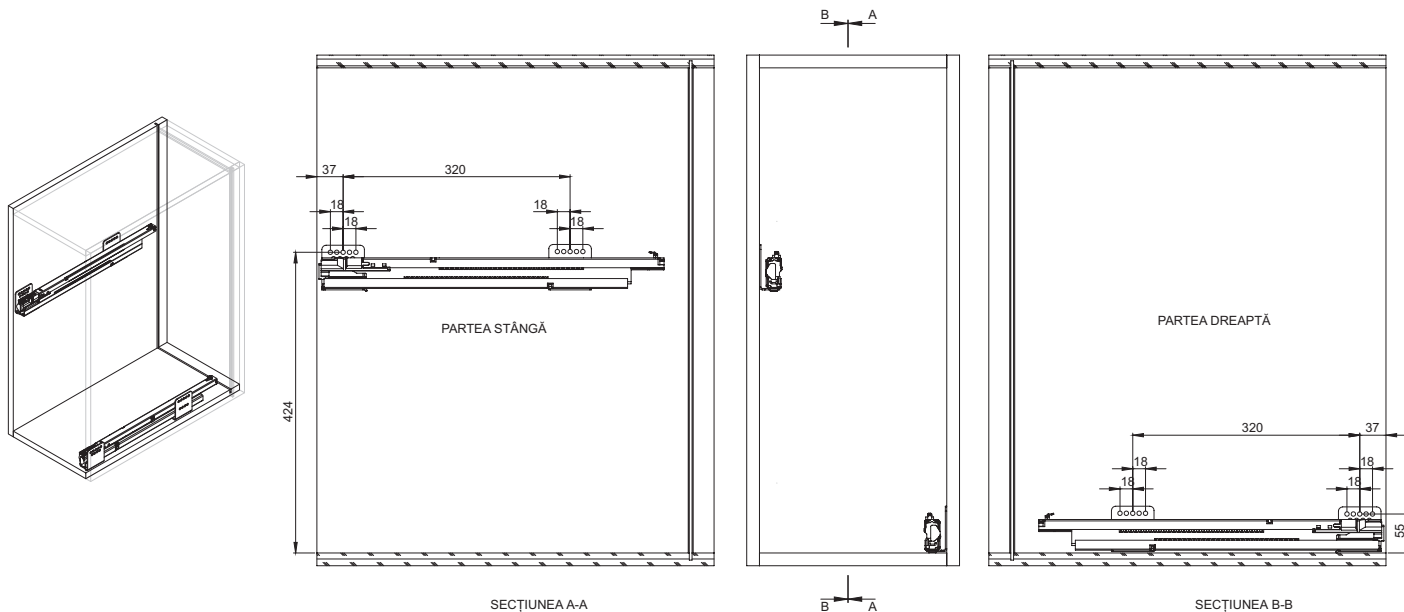

Trageți glisierile și fixați coșul.

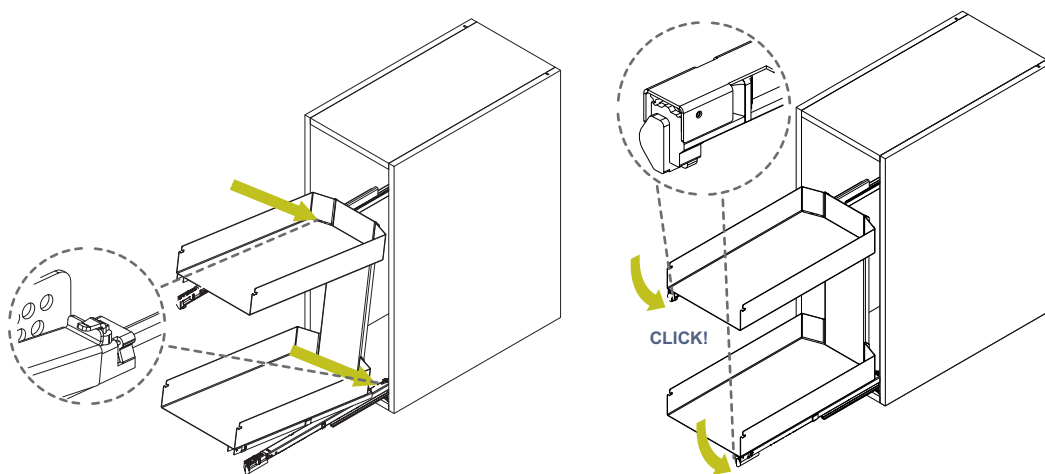

Găuriți ușa (Ø5x10mm) respectând indicațiile de mai jos, apoi montați plăcuțele D cu 4 euroșuruburi 6.3x14.

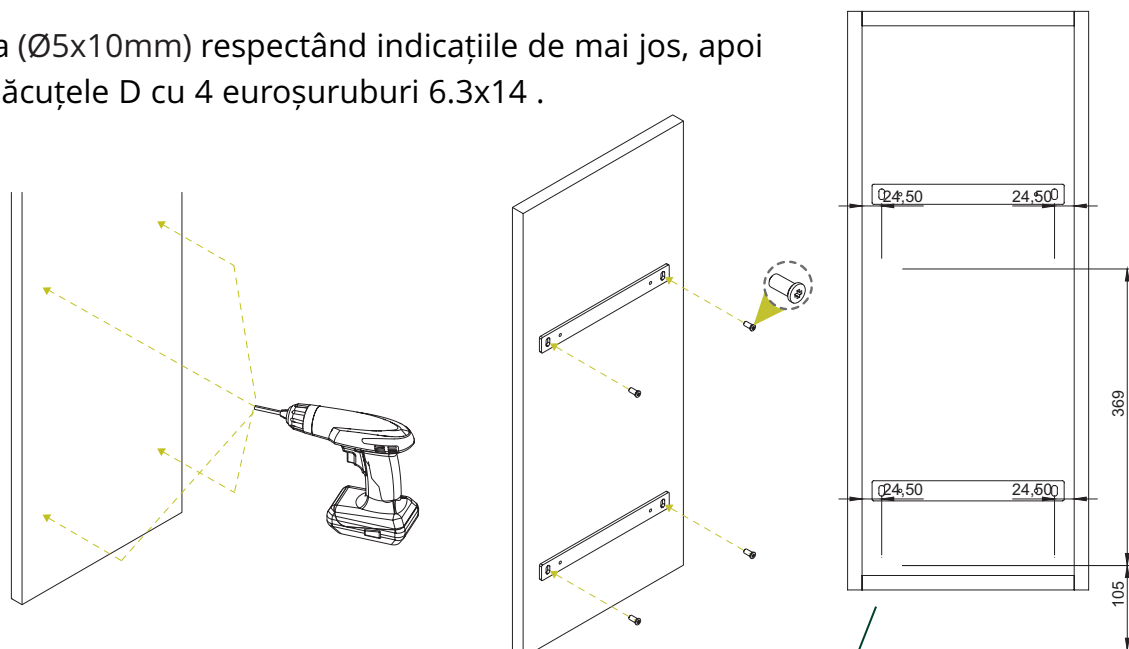

Fixați clemele de prindere (C) de plăcuțe (D).
Montați două șuruburi M5x5 în lateralele clemei superioare.

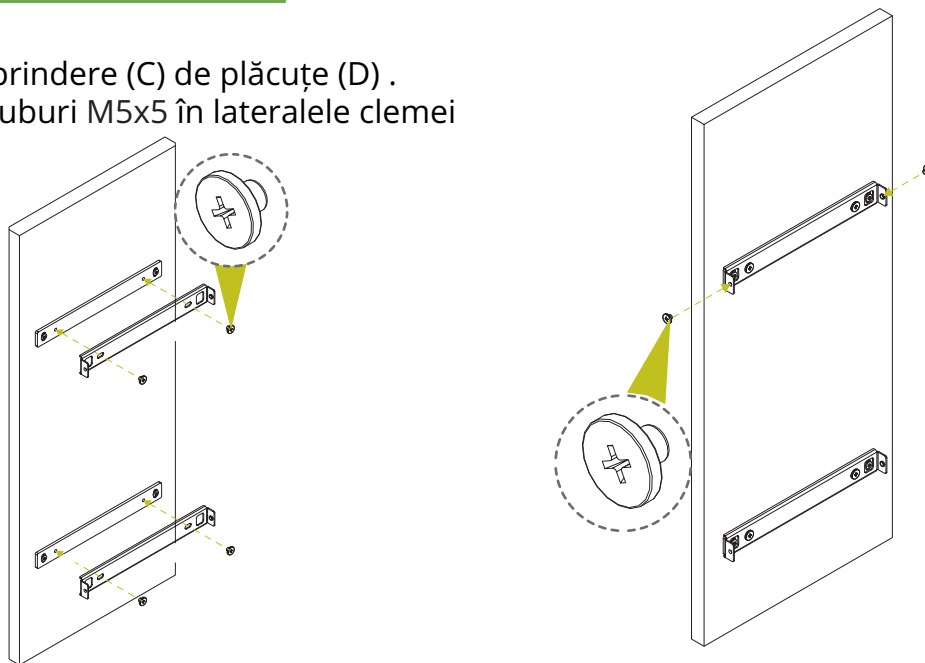

Montați ușa, utilizând 2 șuruburi M5x5 în clema inferioară și apoi strângeți-le pe toate 4.

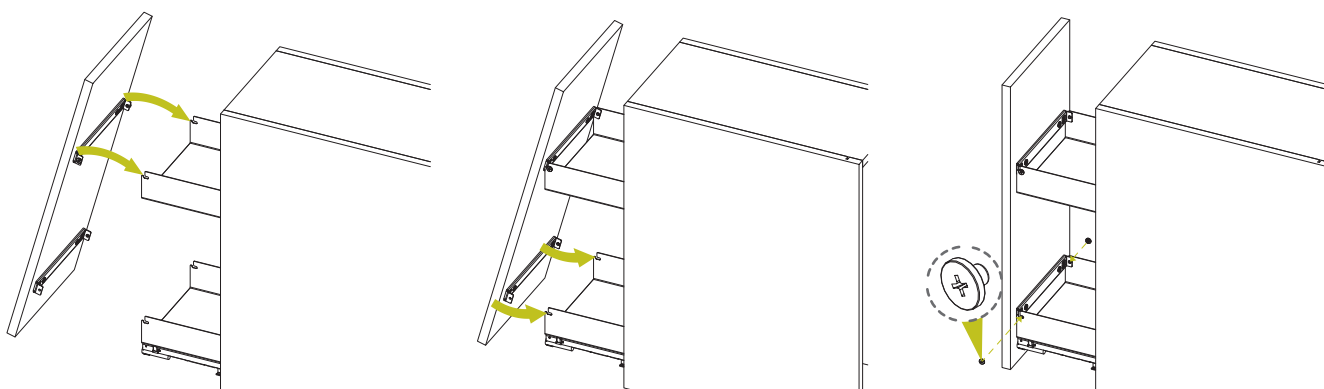

Efectuați reglajele.

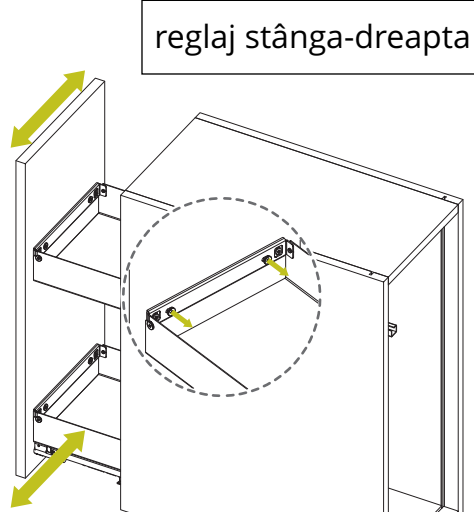
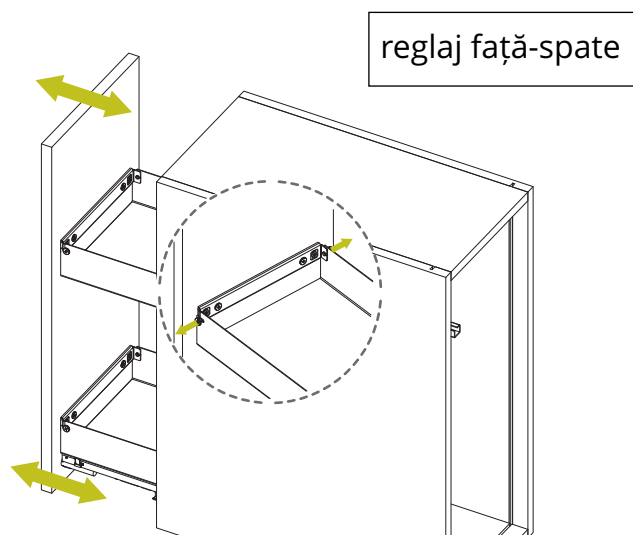

reglaj sus-jos

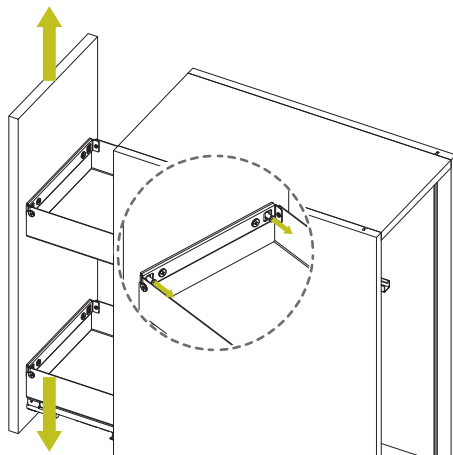

Introduceți capacele de acoperire (F).

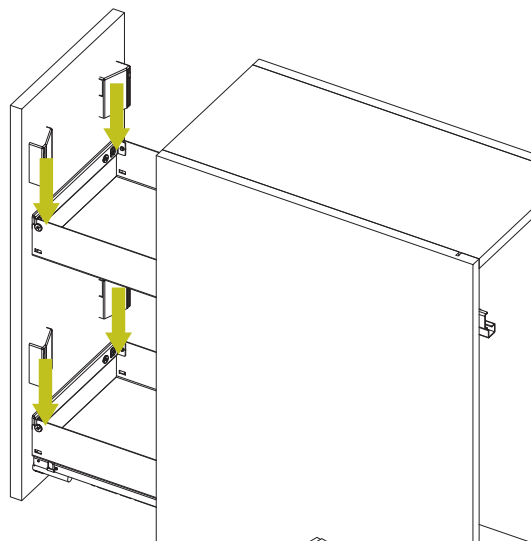

ACCESORII

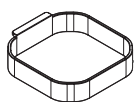

Art.066M

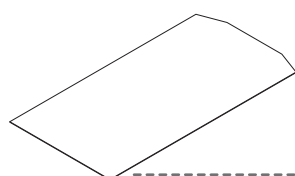
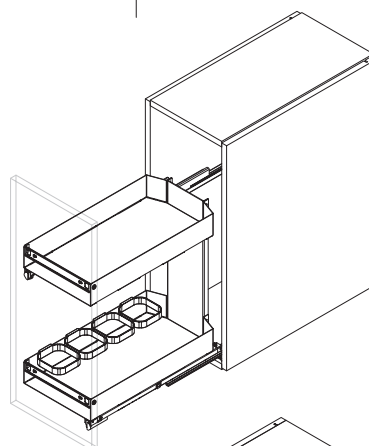

Art.056M

