

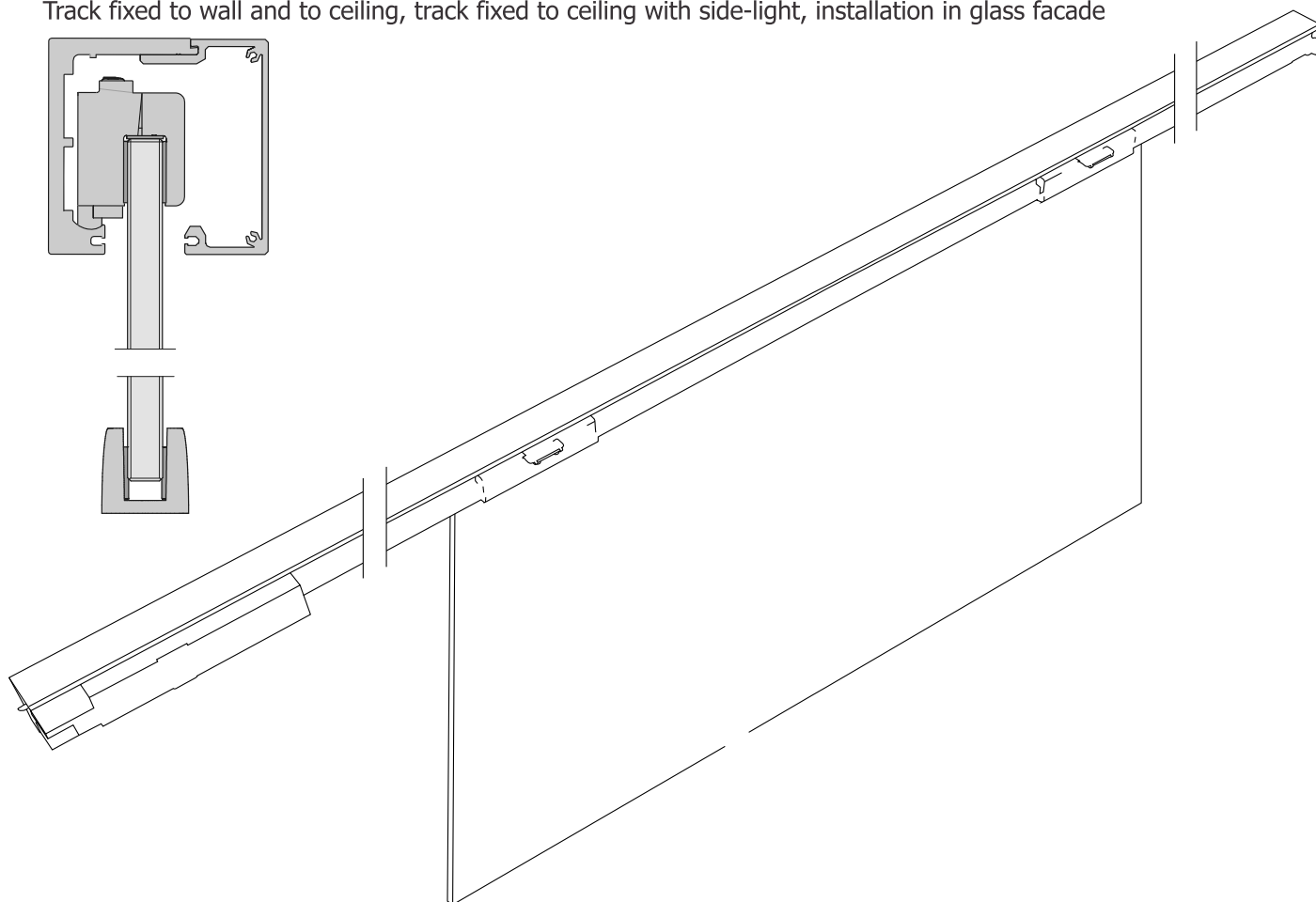

vitris

Mounting instructions Portavant 80 Automatic

Track fixed to wall and to ceiling, track fixed to ceiling with side-light, installation in glass facade



Portavant 80 - instrucțiuni de montaj

Uși glisante din sticlă acționate electronic



ACCESORIA GROUP

House of innovation

vitris

Important information

Scope of delivery

* Option

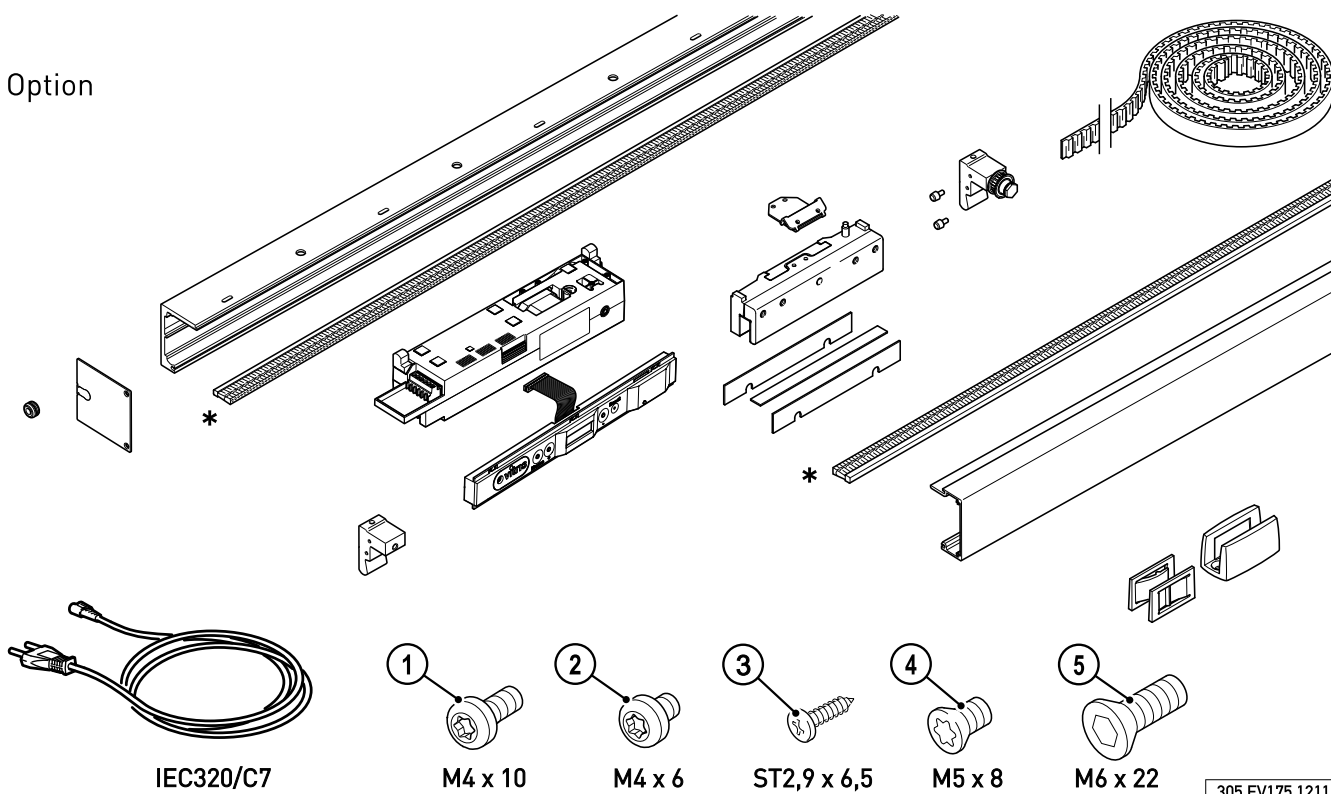

Important notes

Glass thicknesses (Nominal dimension)		
ESG1)	VSG1)	<p>The maximum height-width ratio of the sashes is 2.5:1. The maximum weight (door mass) for doors with 1 sash is 80 kg, for doors with double sash 60 kg per sash.</p>
8 mm	8,76 mm	
10 mm	10,76 mm	
12 mm	12,76 mm	

- 1) Toughened glass
Laminated safety glass



vitris

Planning criteria

Tools

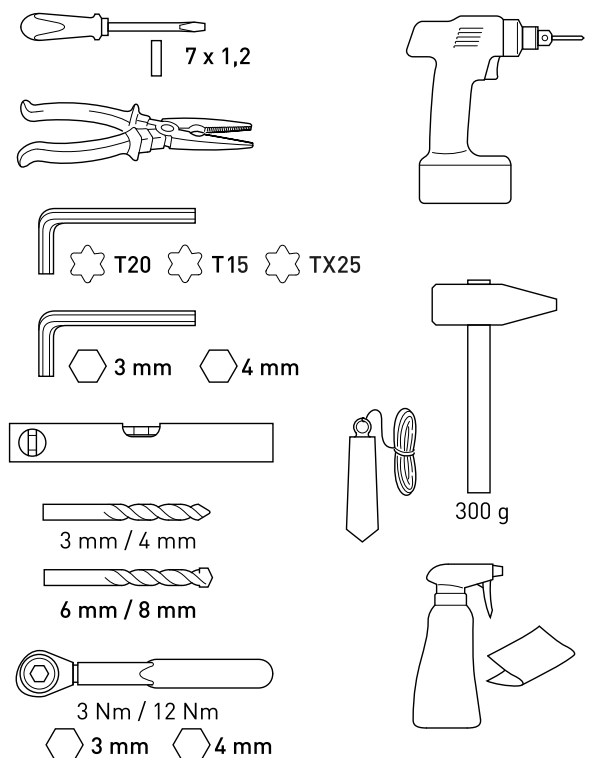

308.EV175.1211

Sash height
Glass façade/Wall mounting

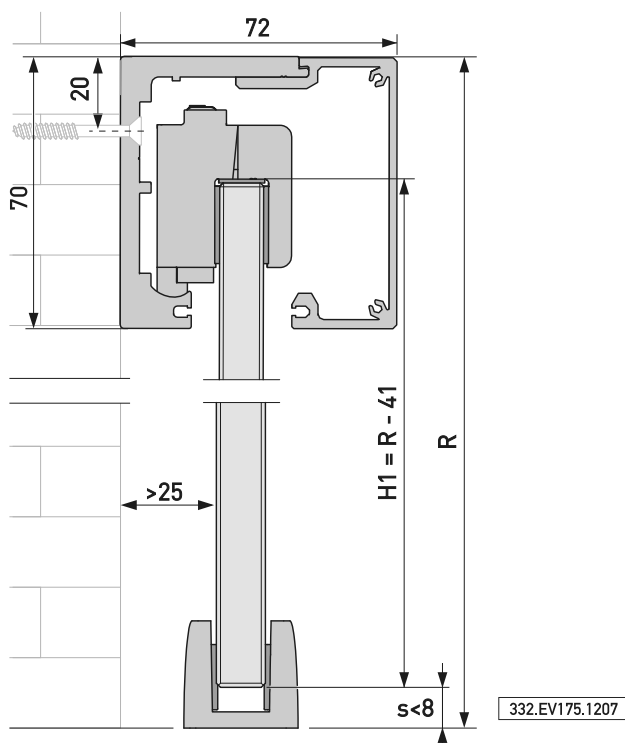

Sash height
Ceiling mounting

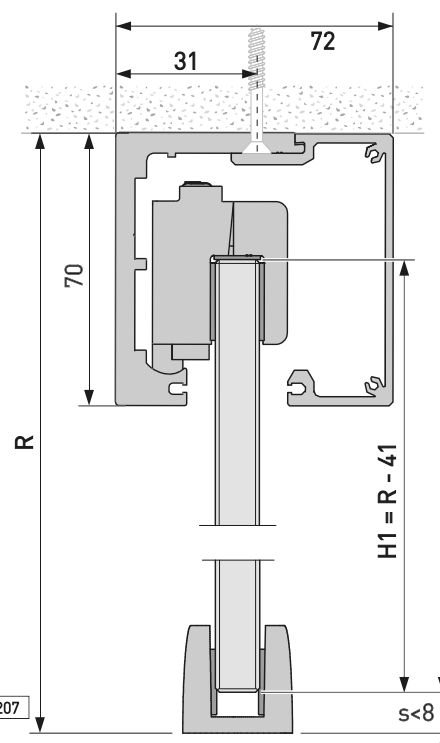



Planning criteria Standard

Dimensions wall/ceiling mounting

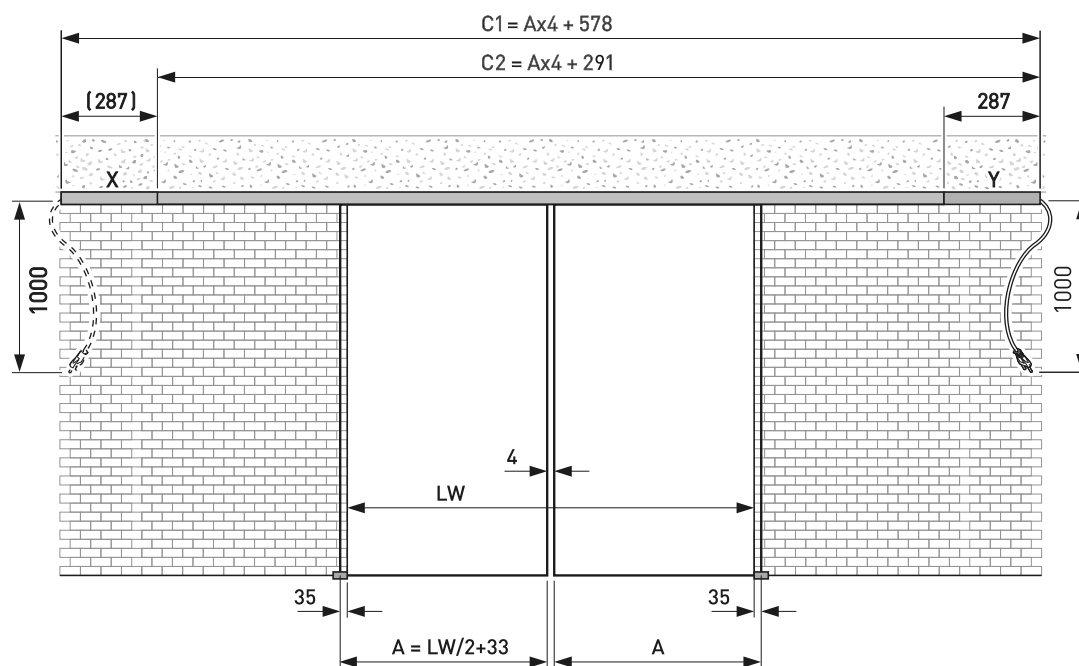

356.EV175.1211

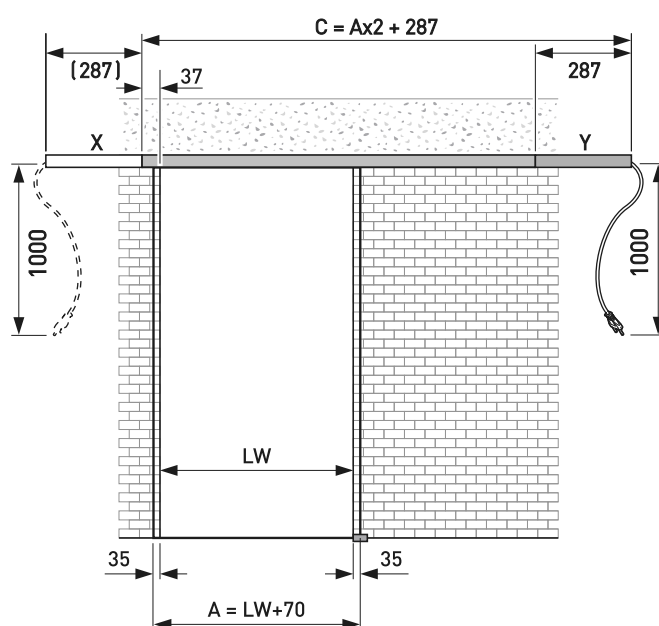

306.EV175.1211



Planning criteria side-light

Dimensions

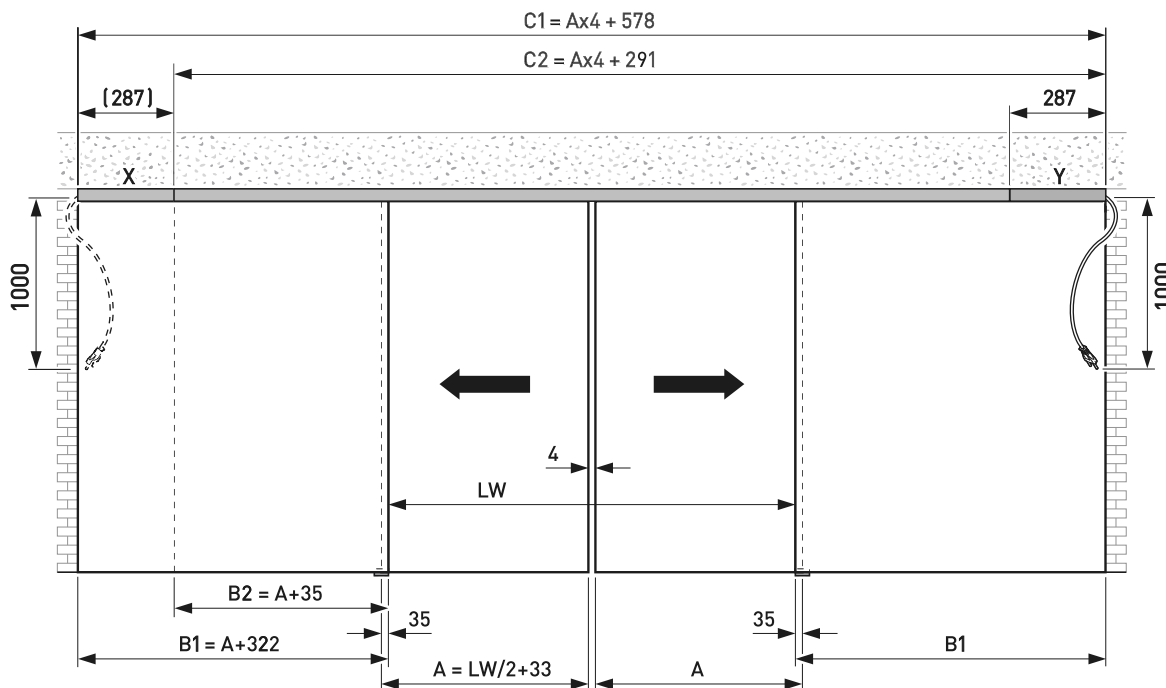

357.EV175.1211

Dimensions

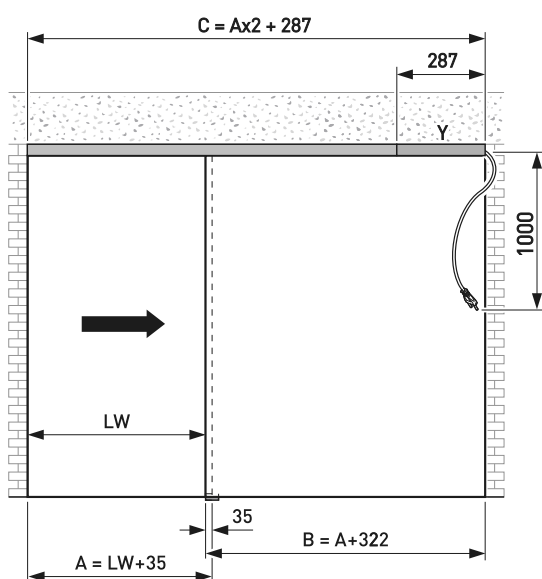

358.EV175.1209

Sash height Ceiling mounting

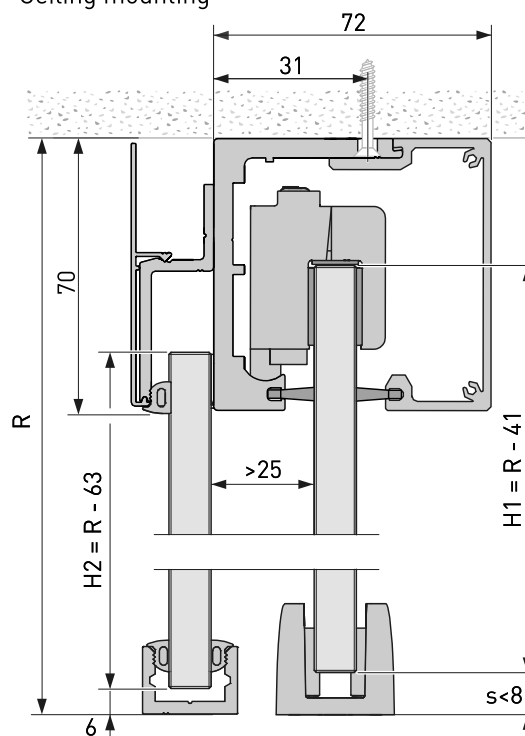

354.EV175.1209

Portavant 80 - instrucțiuni de montaj

Uși glisante din sticlă acționate electronic



ACCESORIA GROUP

House of innovation

vitris

Top track side-light

Preparation

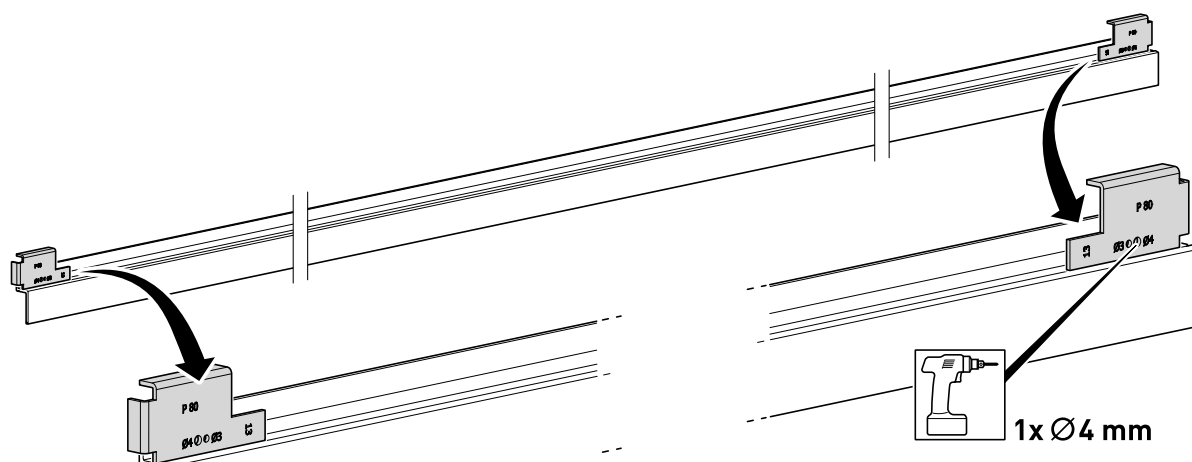
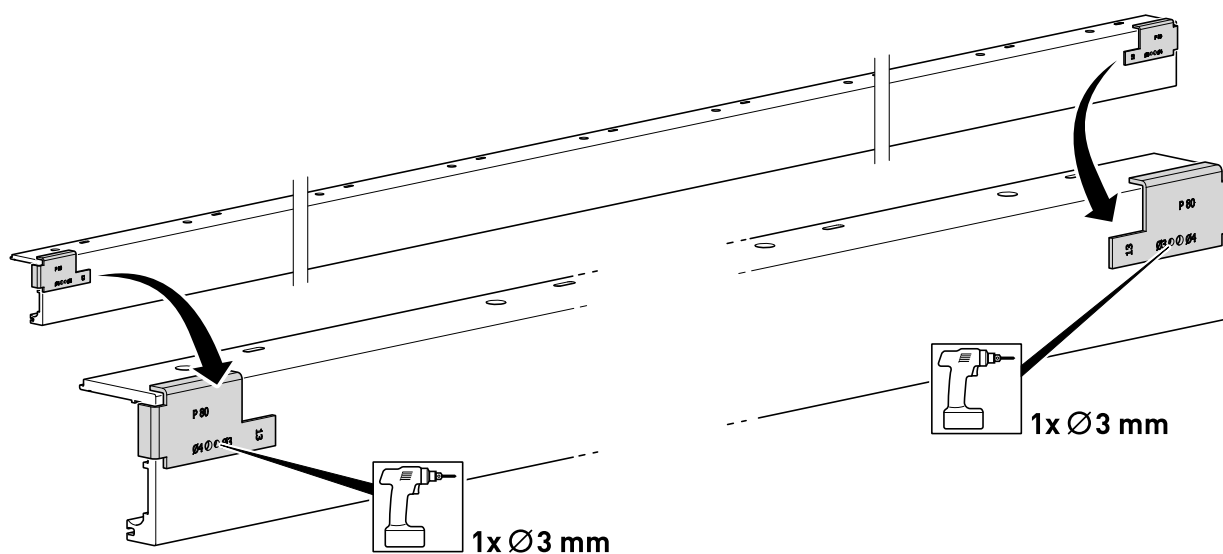
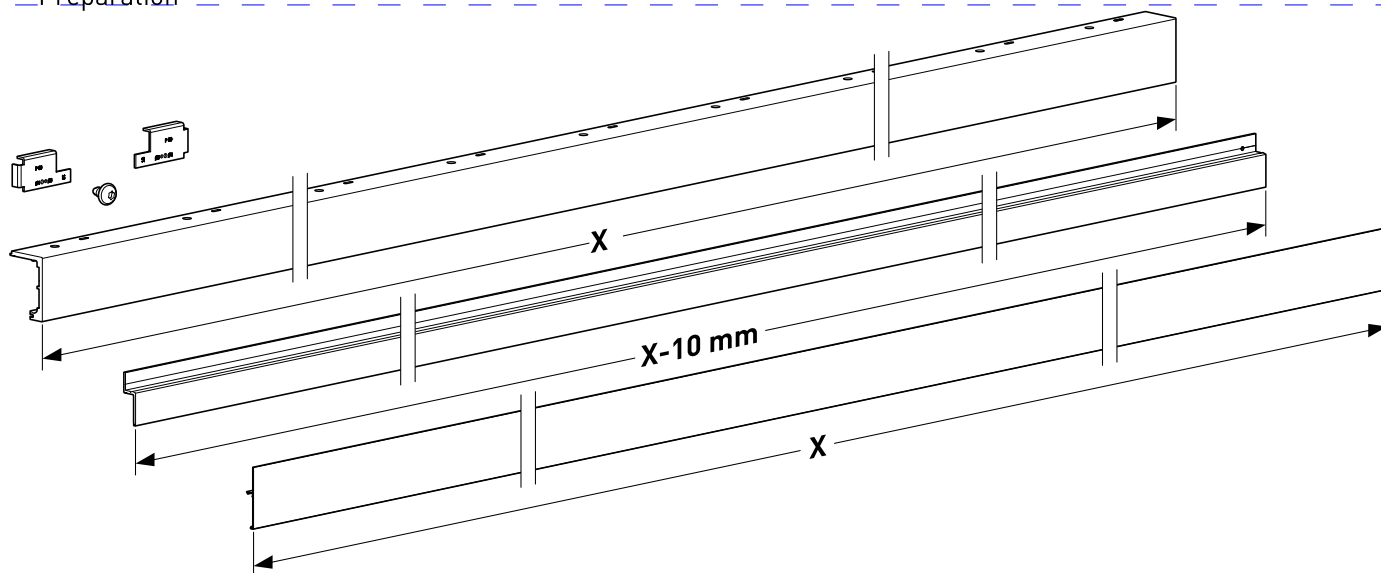

396.EV175.1211



vitris

Top track side-light

Preparation

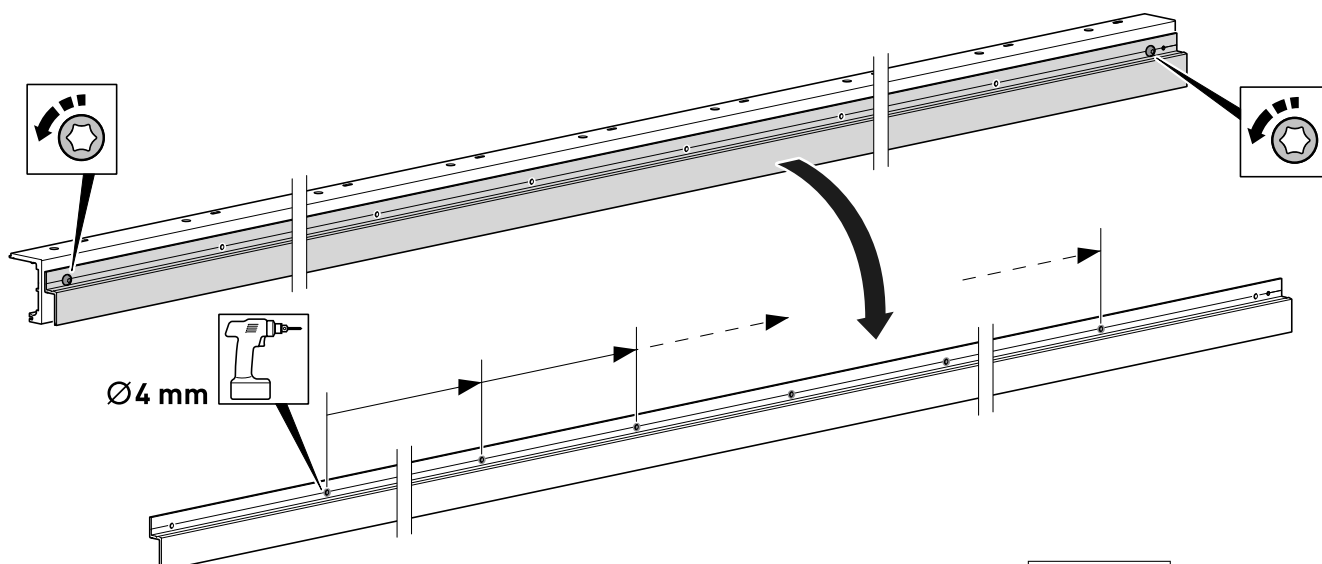
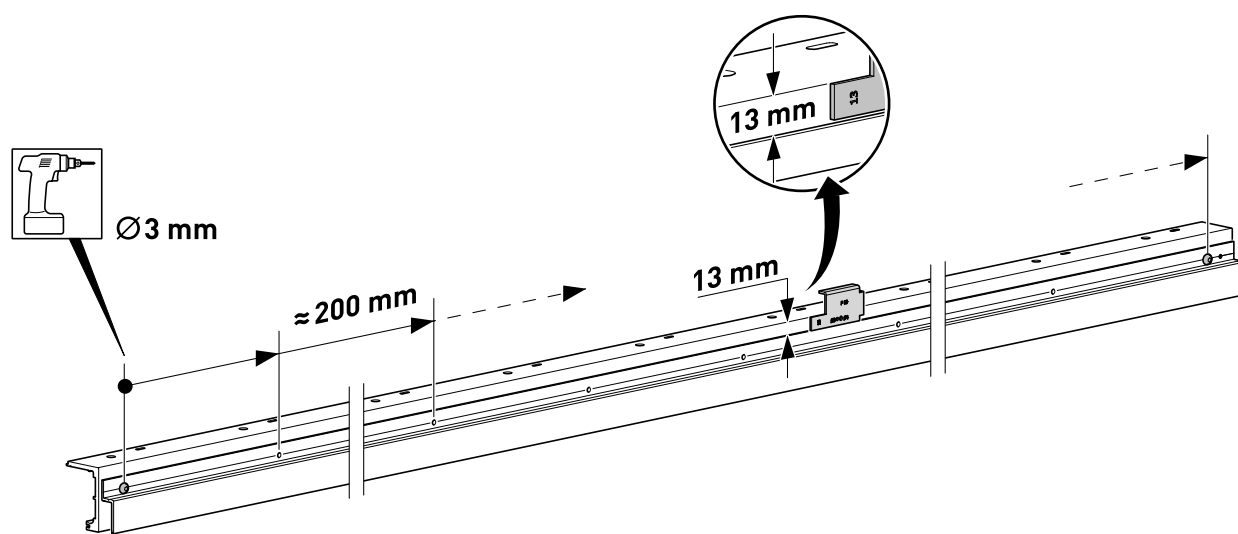
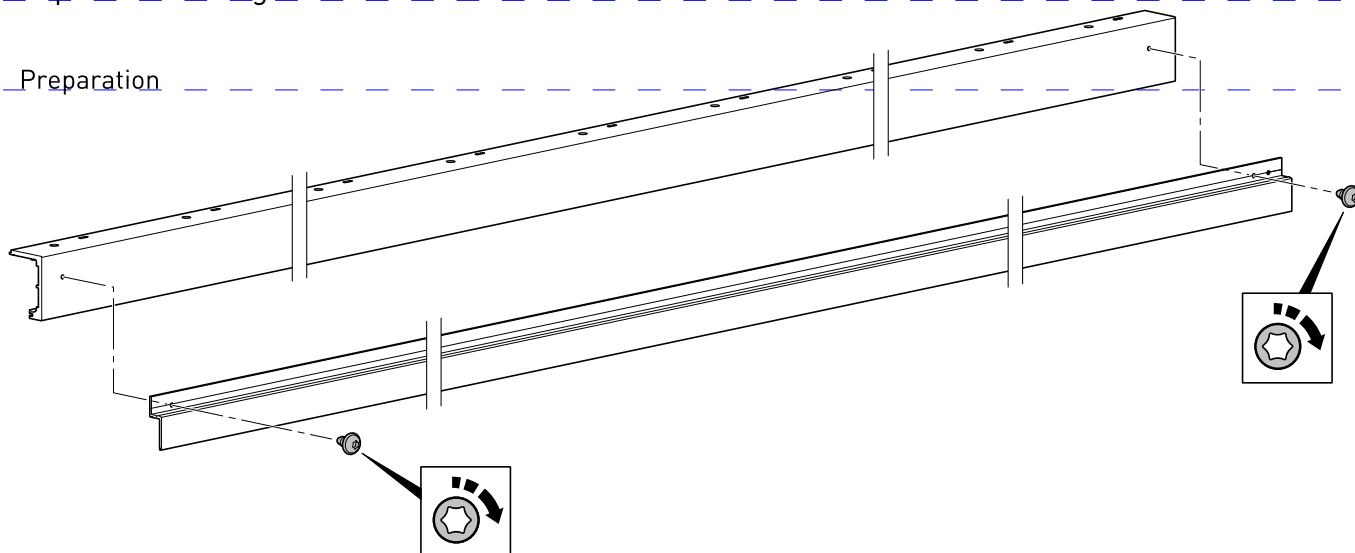

399.EV175.1211

Portavant 80 - instrucțiuni de montaj

Uși glisante din sticlă acționate electronic



ACCESORIA GROUP

House of innovation

vitris

Top track side-light

Preparation

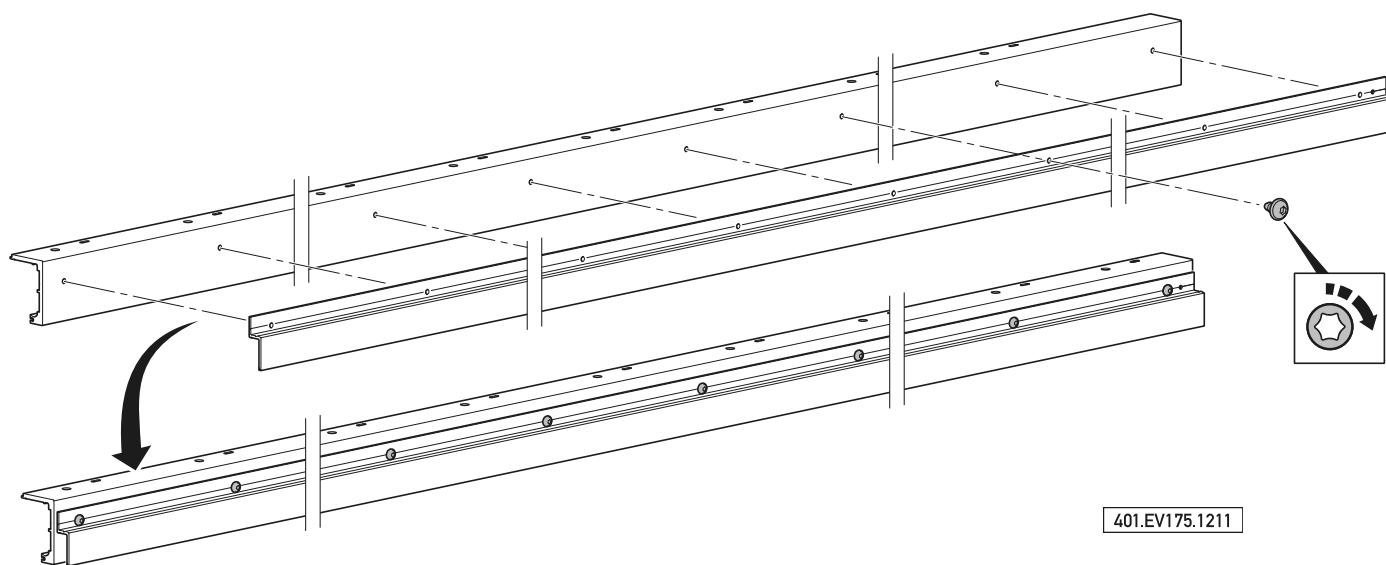
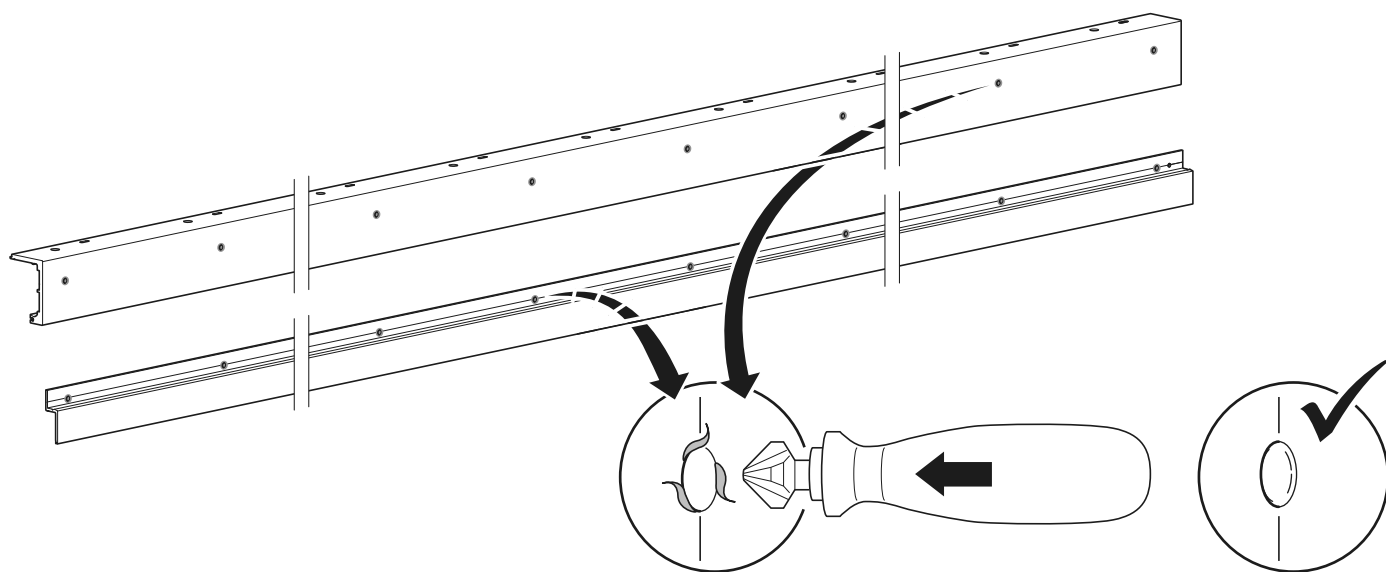

401.EV175.1211



vitris

Top track side-light

Preparation



Caution!

Do not bend the cover profile when installing!

- Gradually press on the cover profile.
- Only push in the web area.

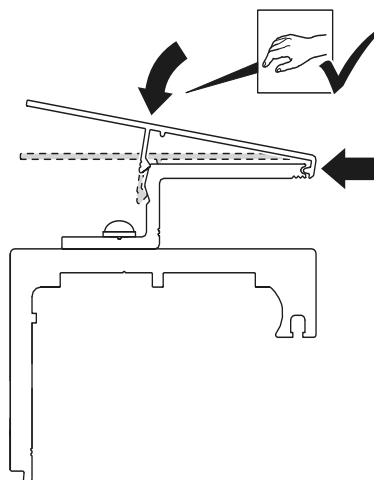
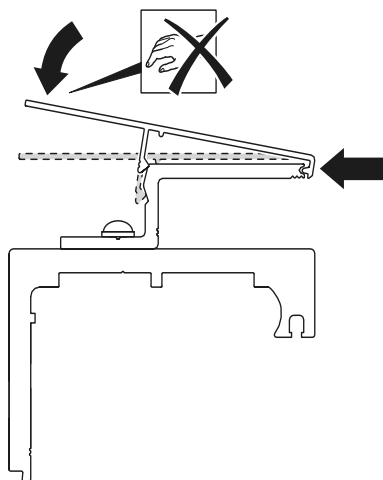

402.EV175.1211

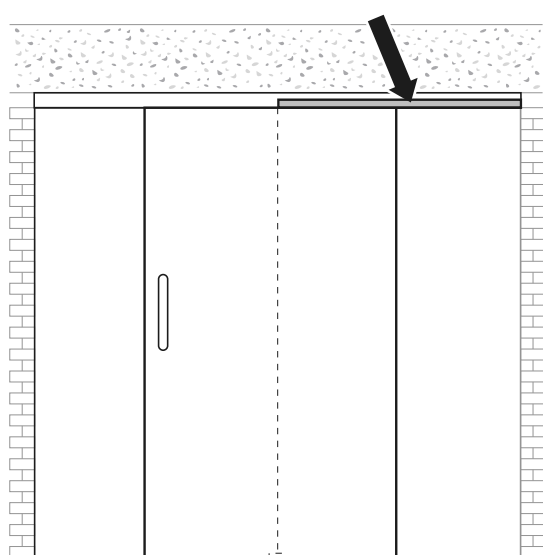

339.EV174.1208

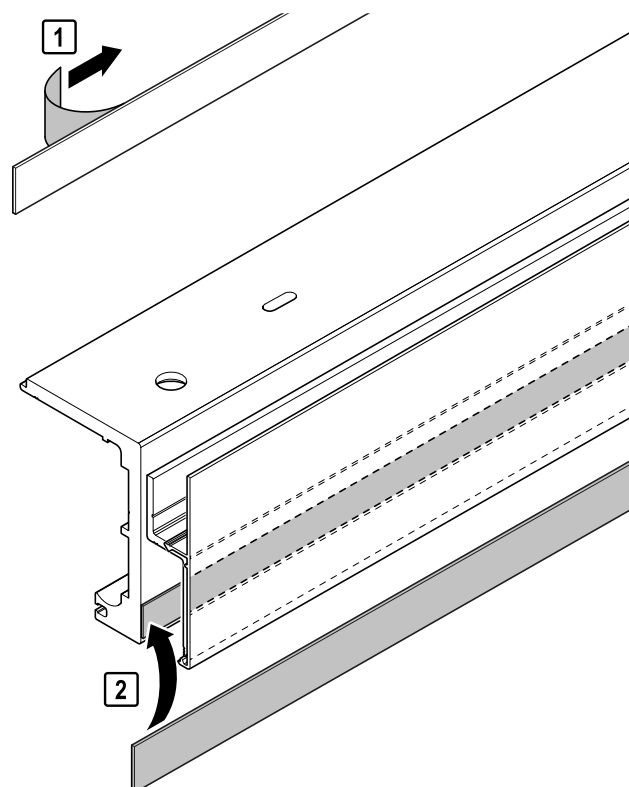

377.EV175.1211



vitris

Top track

In case of wall mounting

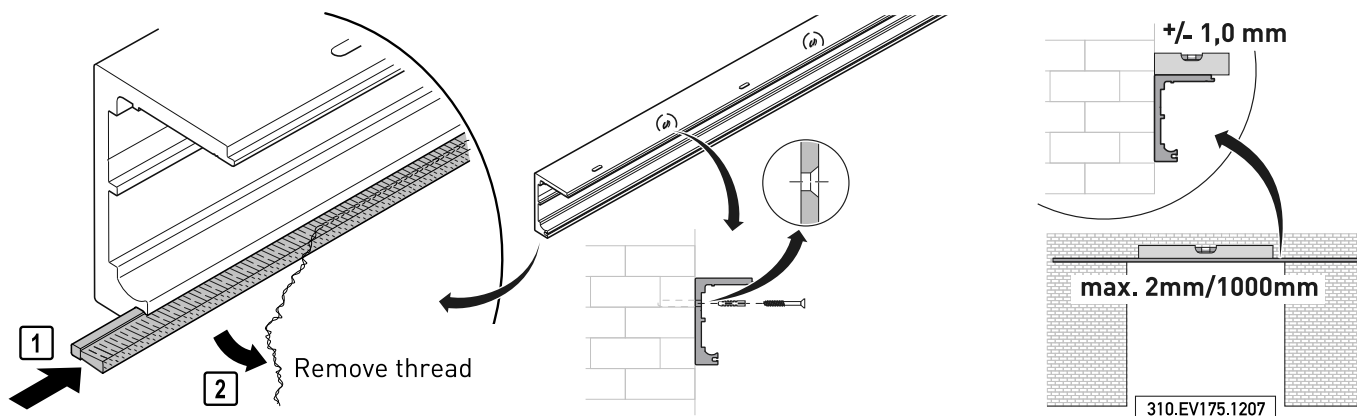

Risk of injury!

- Insert screw into each drill hole and tighten.



Risk of injury!

- Ensure proper load-bearing capacity of connection and building structure.

In case of ceiling mounting

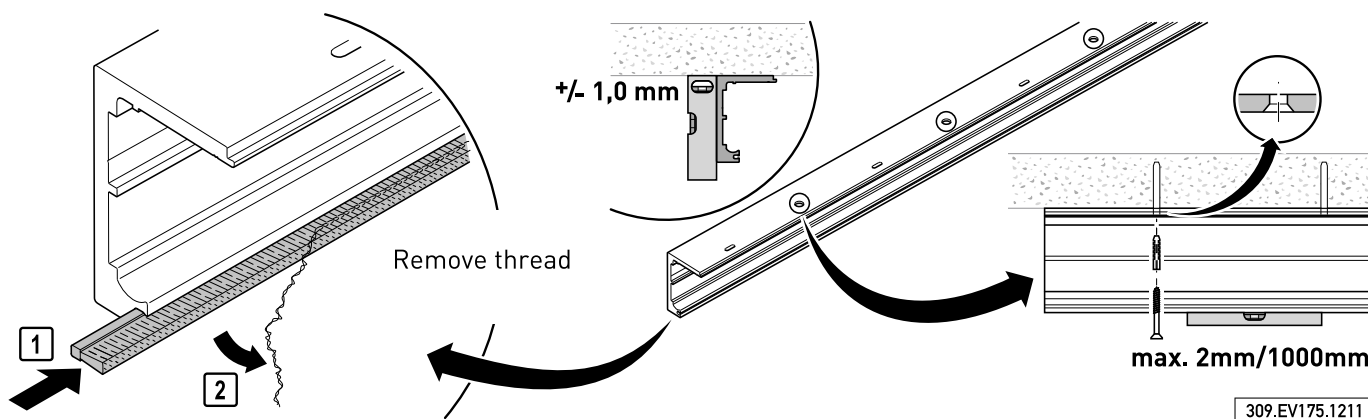

Risk of injury!

- Insert screw into each drill hole and tighten.



Risk of injury!

- Ensure proper load-bearing capacity of connection and building structure.



vitris

Planning criteria glass façade

Dimensions

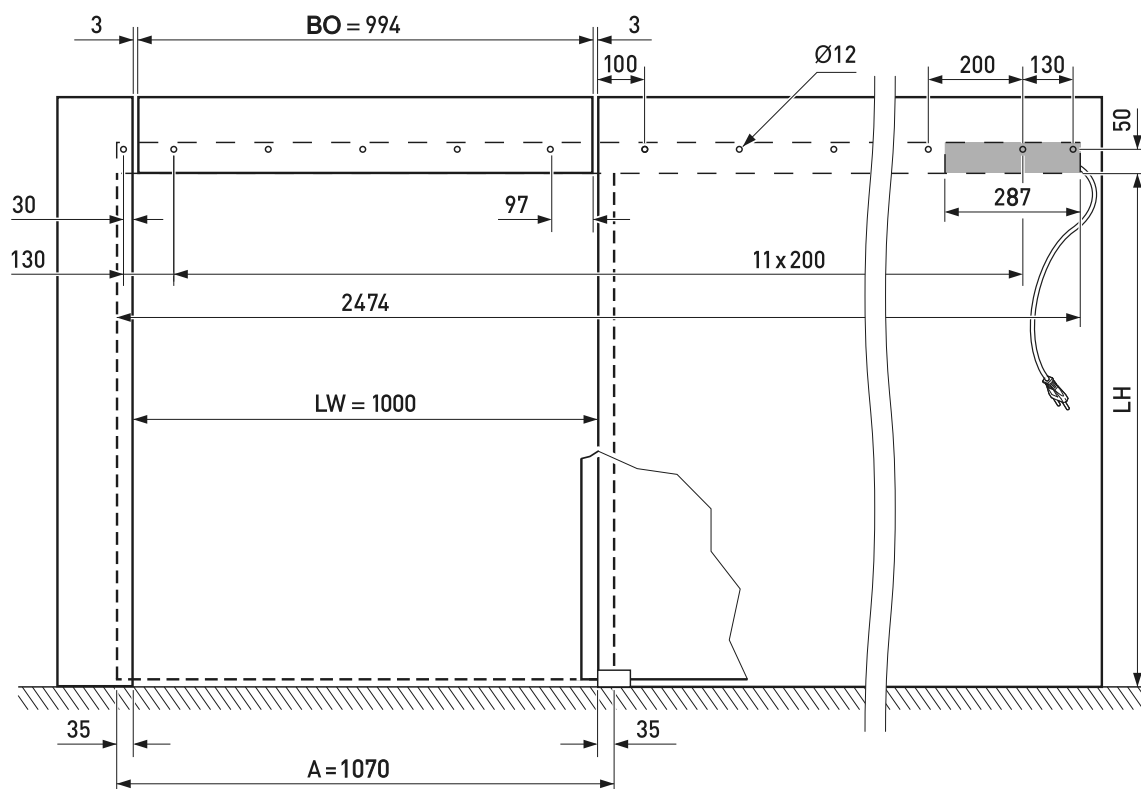

LW = Clear width
 LH = Clear height
 LW_t = Clear width when door open
 A = Glass width of sash
 BO = Transom light width

Diagram shows left door section.
 Glass preparation for right door section is mirror image.



vitris

Planning criteria glass façade

Dimensions

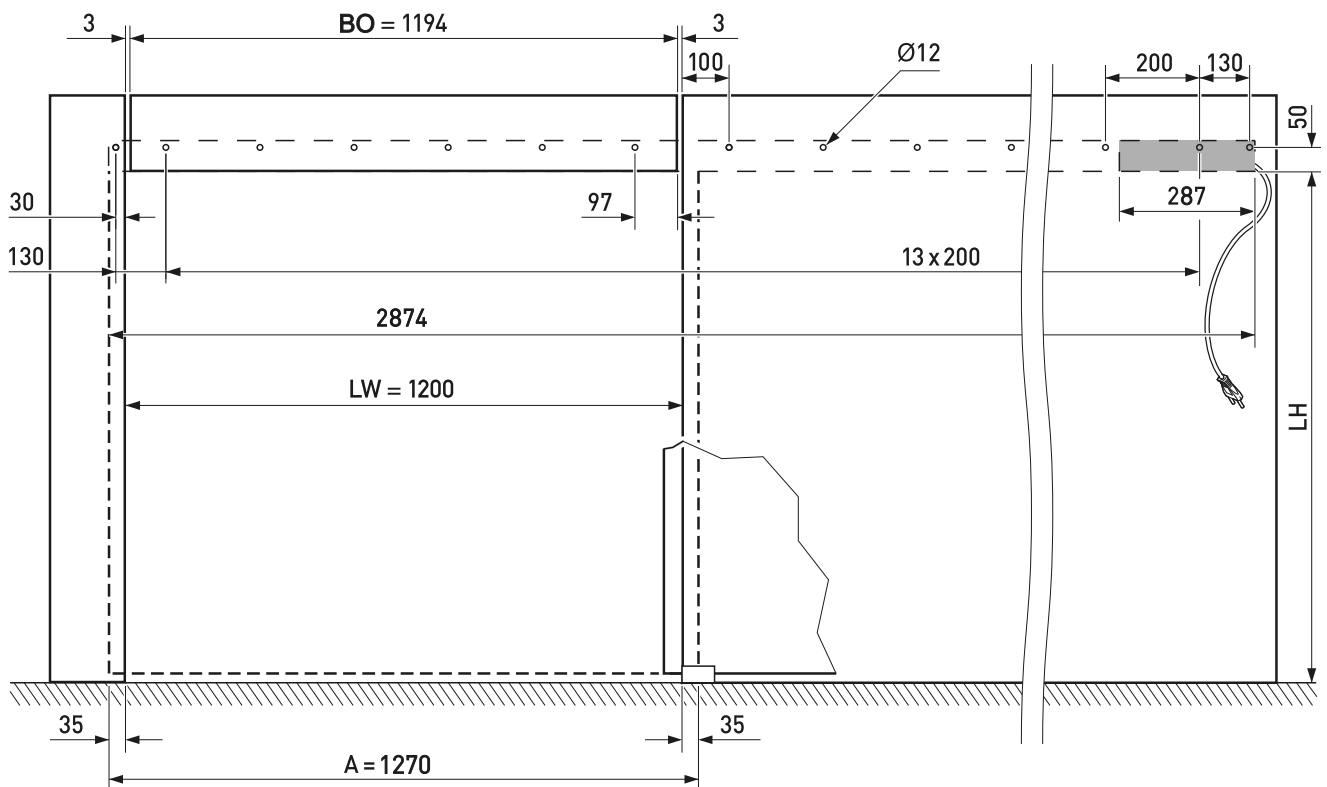

360.EV175.1209

LW = Clear width
 LH = Clear height
 LW_t = Clear width when door open
 A = Glass width of sash
 BO = Transom light width

Diagram shows left door section.
 Glass preparation for right door
 section is mirror image.



vitris

Top track: glass façade

Overview

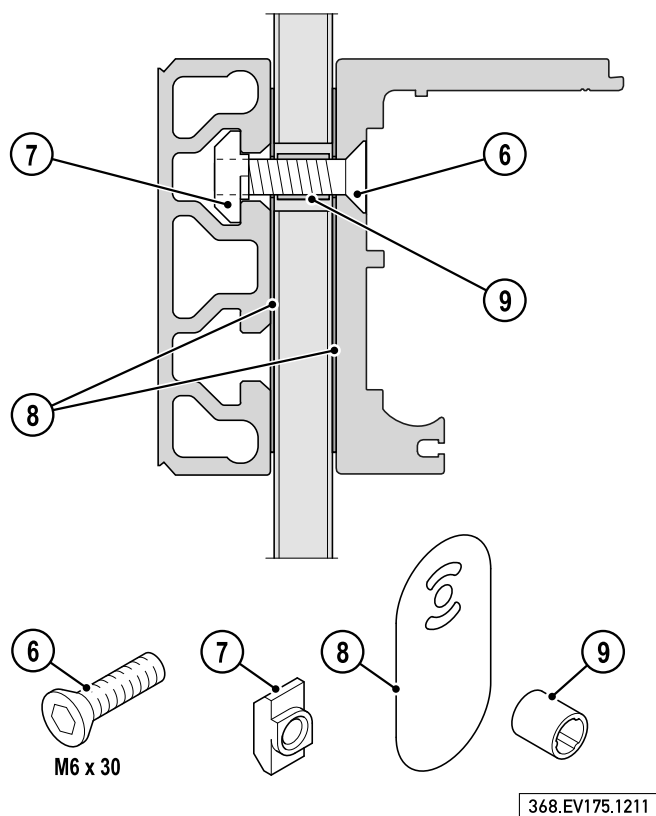

Preparation for installation

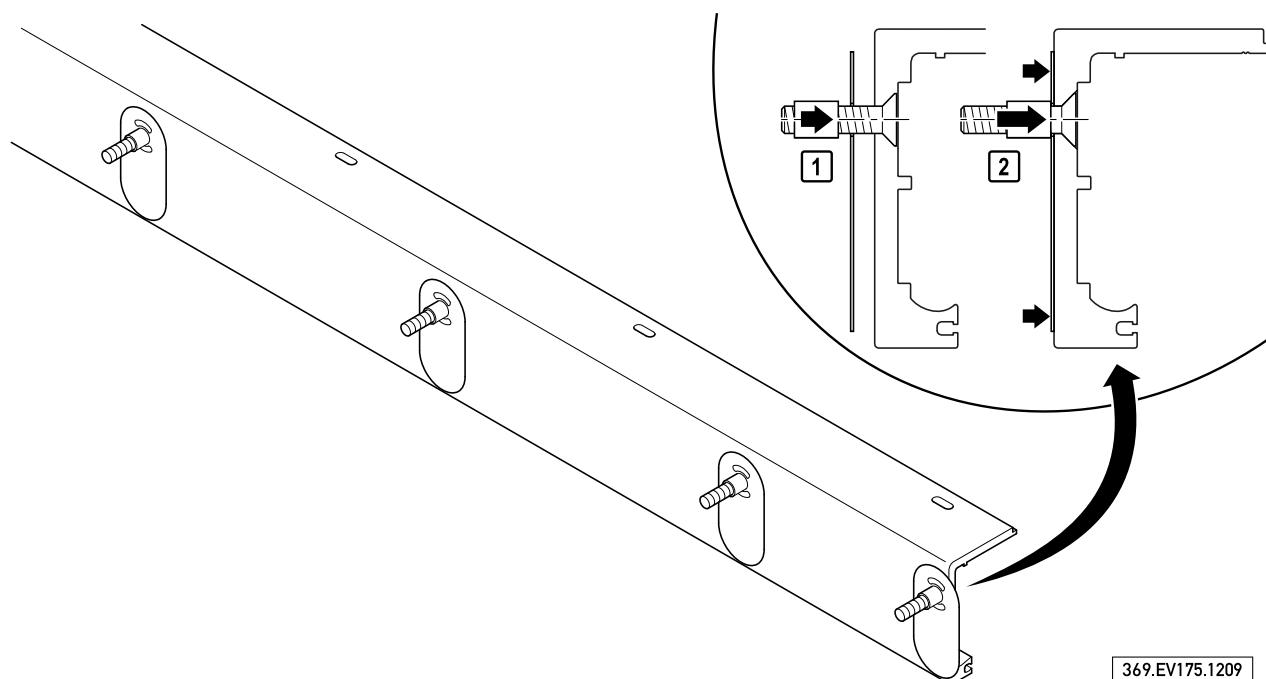



vitris

Top track: glass façade

Assembly of nuts

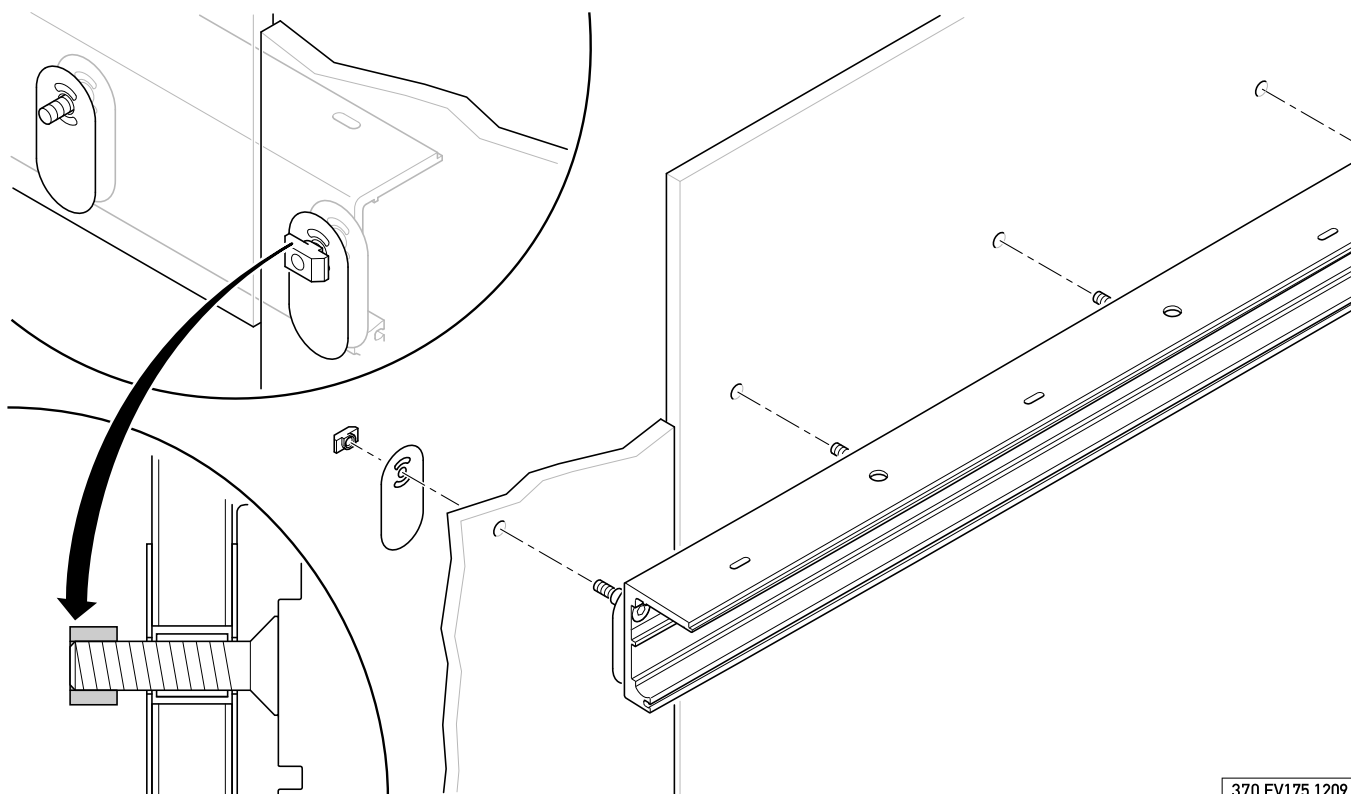

370.EV175.1209

Align nuts

Affix counterprofile

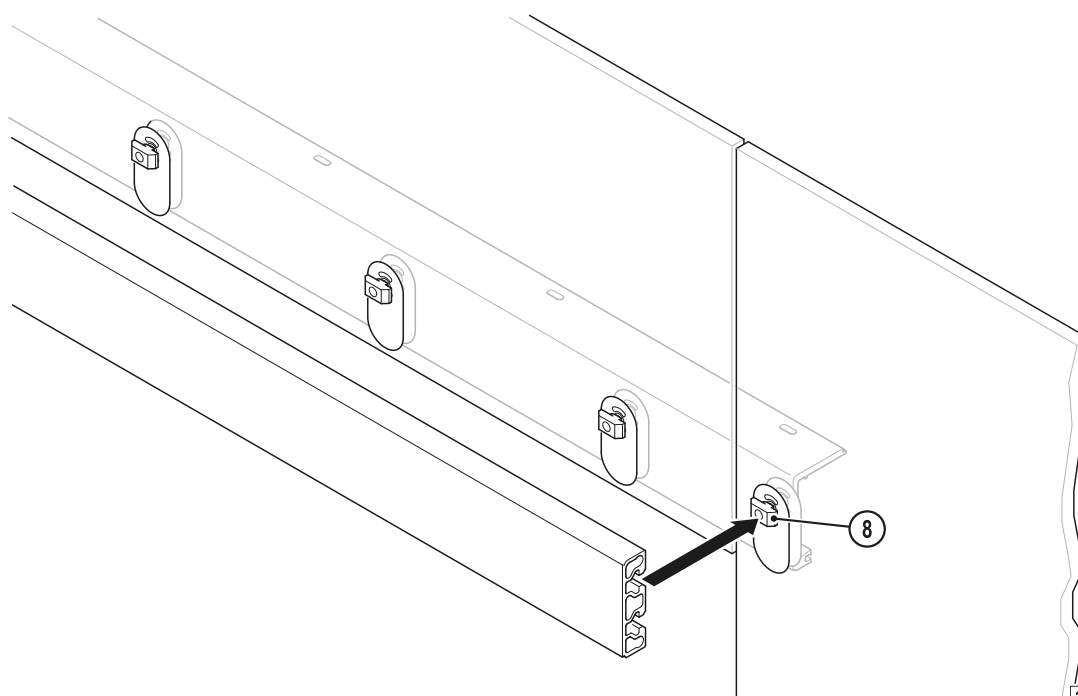

1005.EV166.230



vitris

Top track: glass façade

Alignment of track

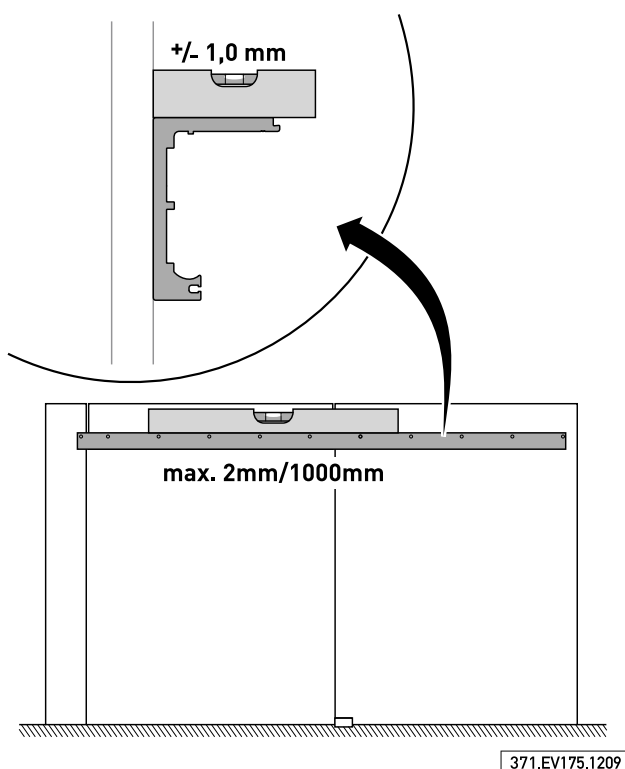

Tighten screws

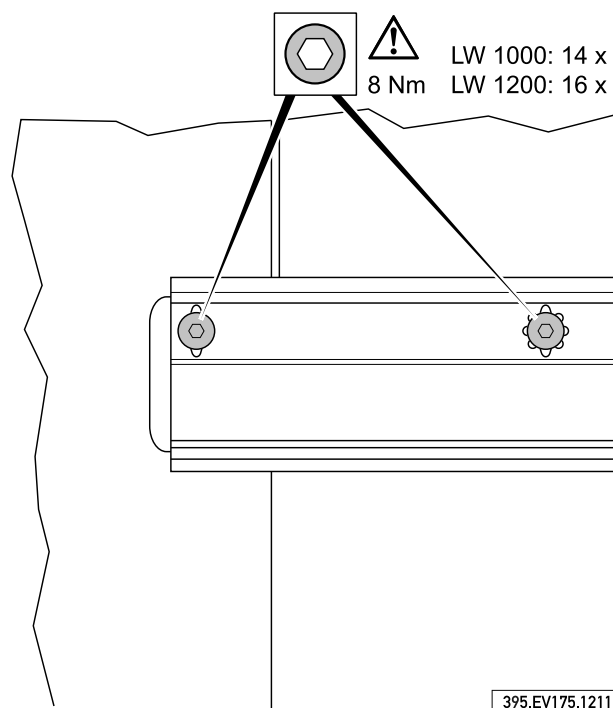

Mask running surfaces

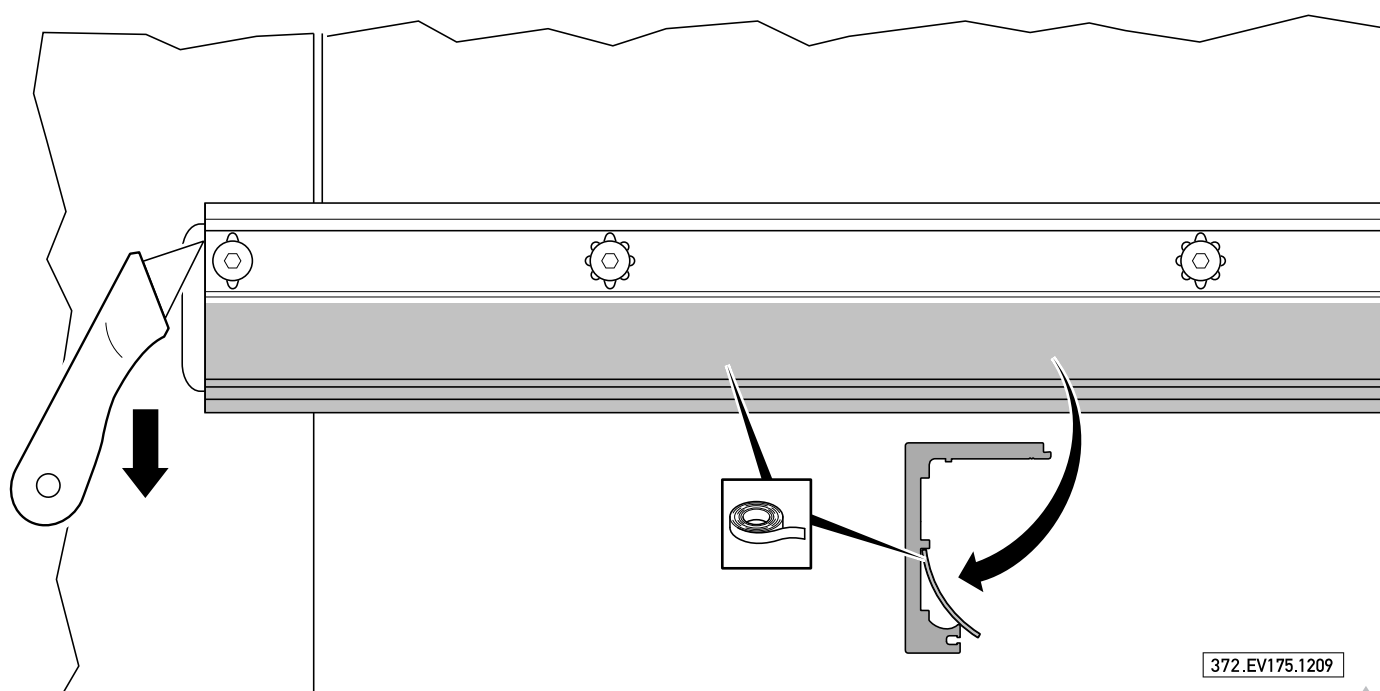



vitris

Top track: glass façade

Injecting adhesive

1. Preparation:

- Remove cap
- Attach mixing nozzle

2. Rapidly inject material into drill hole under screws fill 2/3 of drill hole

 **Material hardens very fast!**

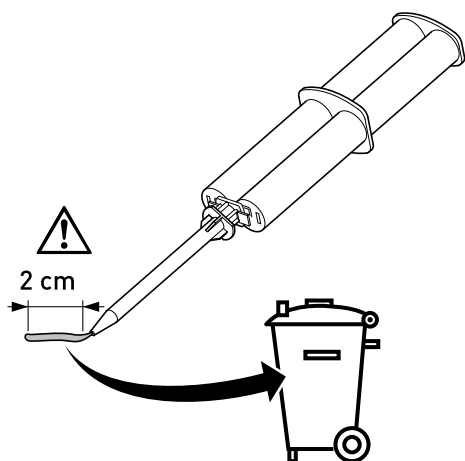

1001.EV166.191

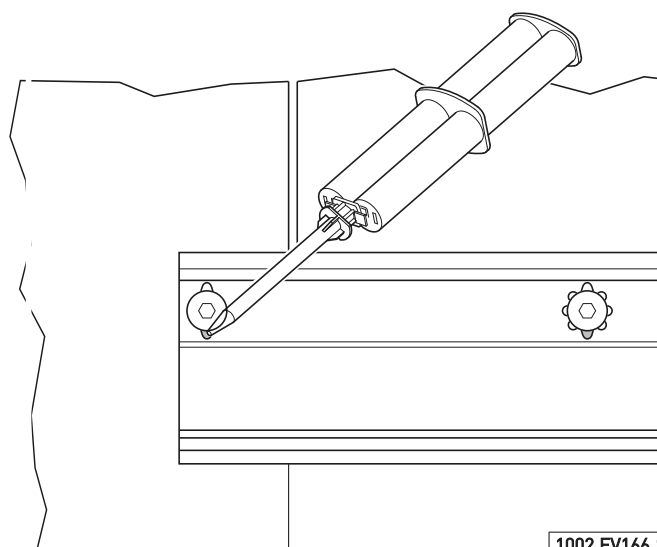

1002.EV166.193

3. Remove excess adhesive.

4. Remove masking tape, clean track.

Portavant 80 - instrucțiuni de montaj

Uși glisante din sticlă acționate electronic



ACCESORIA GROUP

House of innovation

vitris

Floor-guide

Drill holes: standard

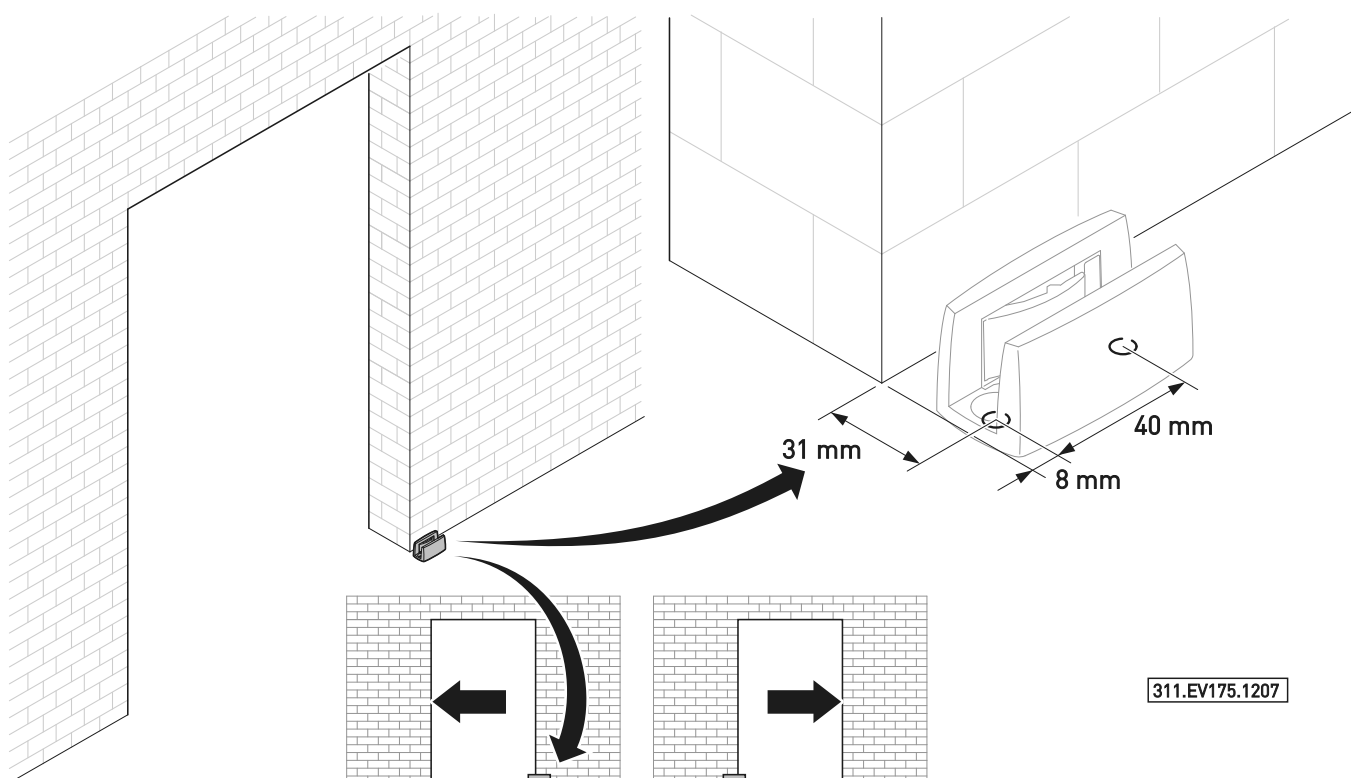

Drill holes: side-light

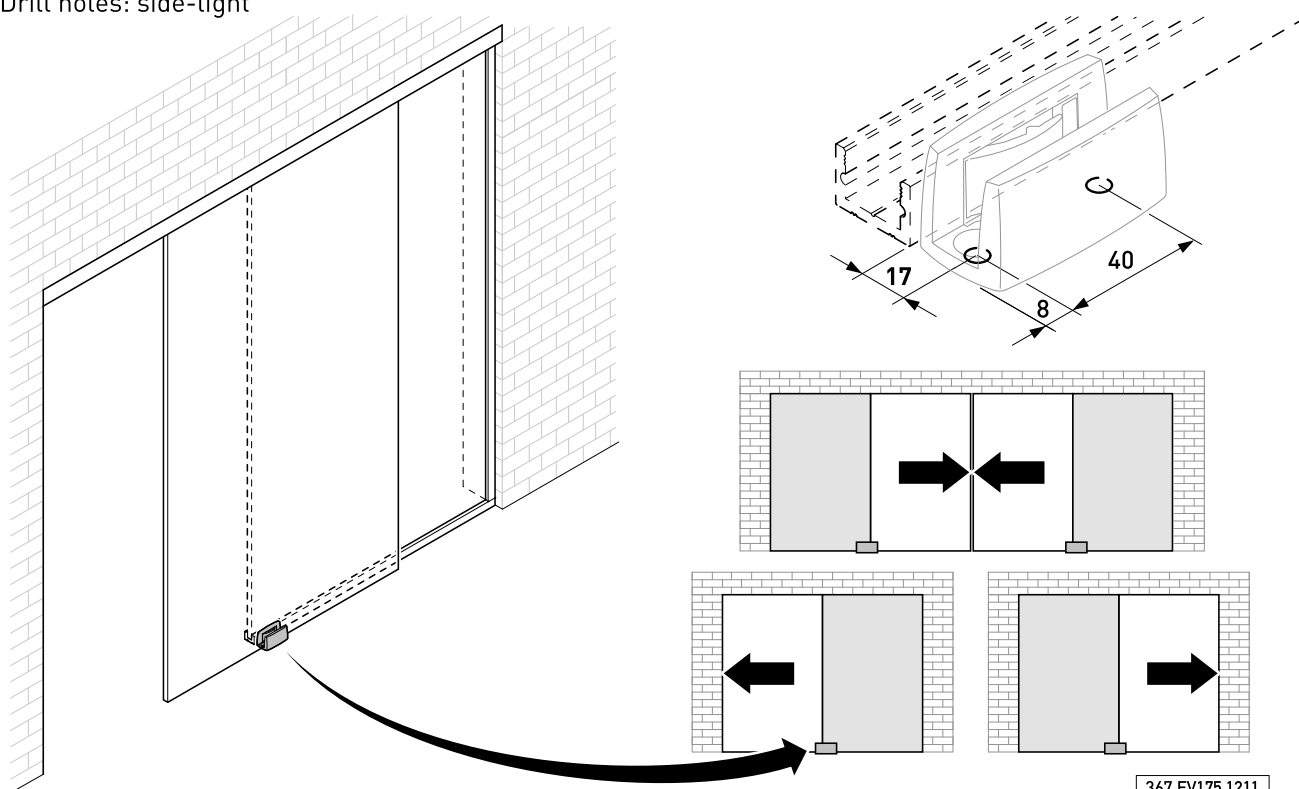



vitris

Floor-guide

Assembly of floor-guide

ESG 8 / VSG 8,76

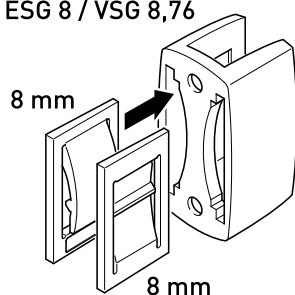

ESG 10 / VSG 10,76

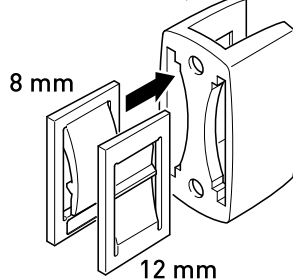

ESG 12 / VSG 12,76

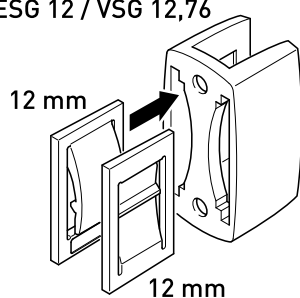

Toughened glass

Laminated safety glass

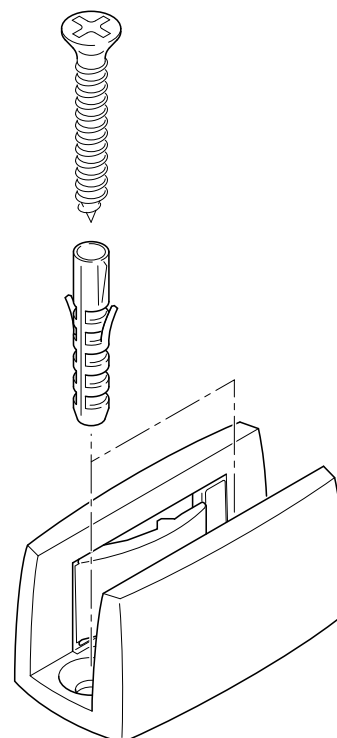

0811.EV166.007



vitris

Stop system

Installation of buffer

X = drive on left side, Y = drive on right side

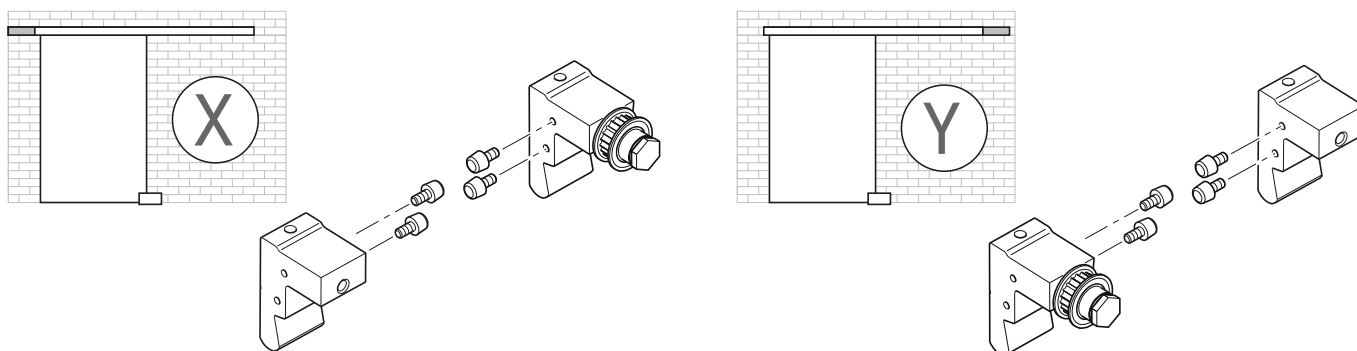

330.EV175.1207

Variation X:

Drive on left side

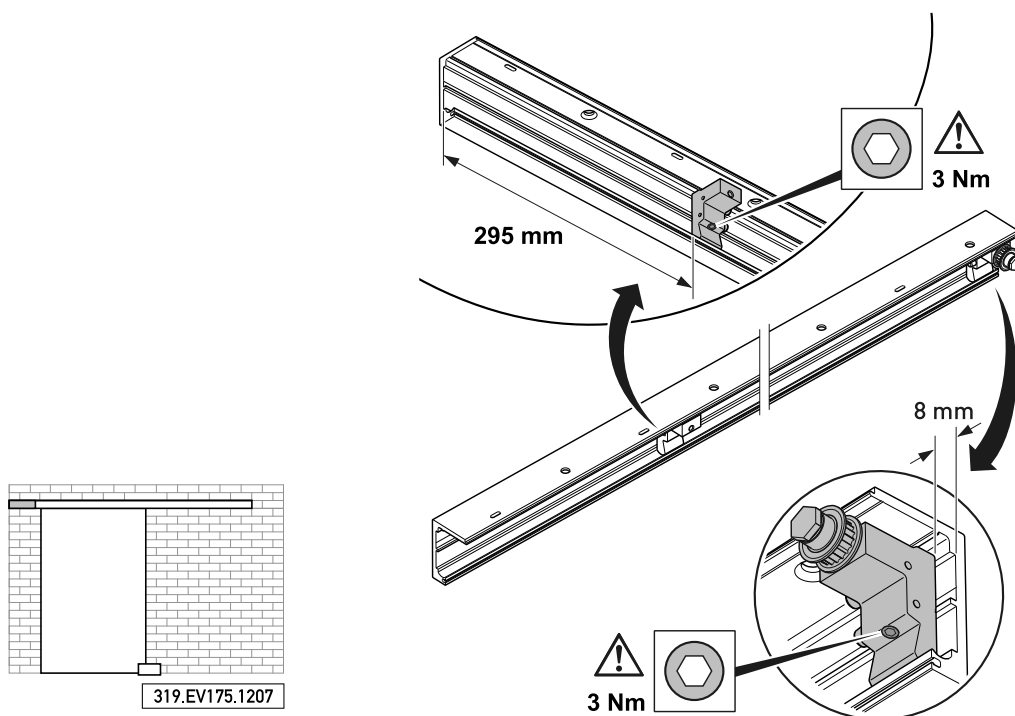

319.EV175.1207

312.EV175.1207



vitris

Stop system

Variation Y:

Drive on right side

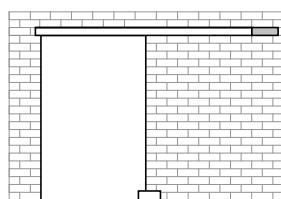

320.EV175.1207

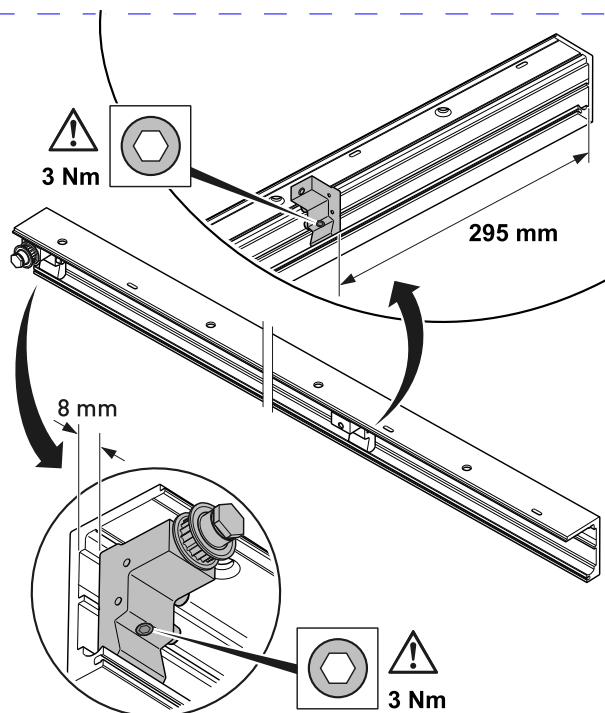

313.EV175.1207

Two-sash sliding door

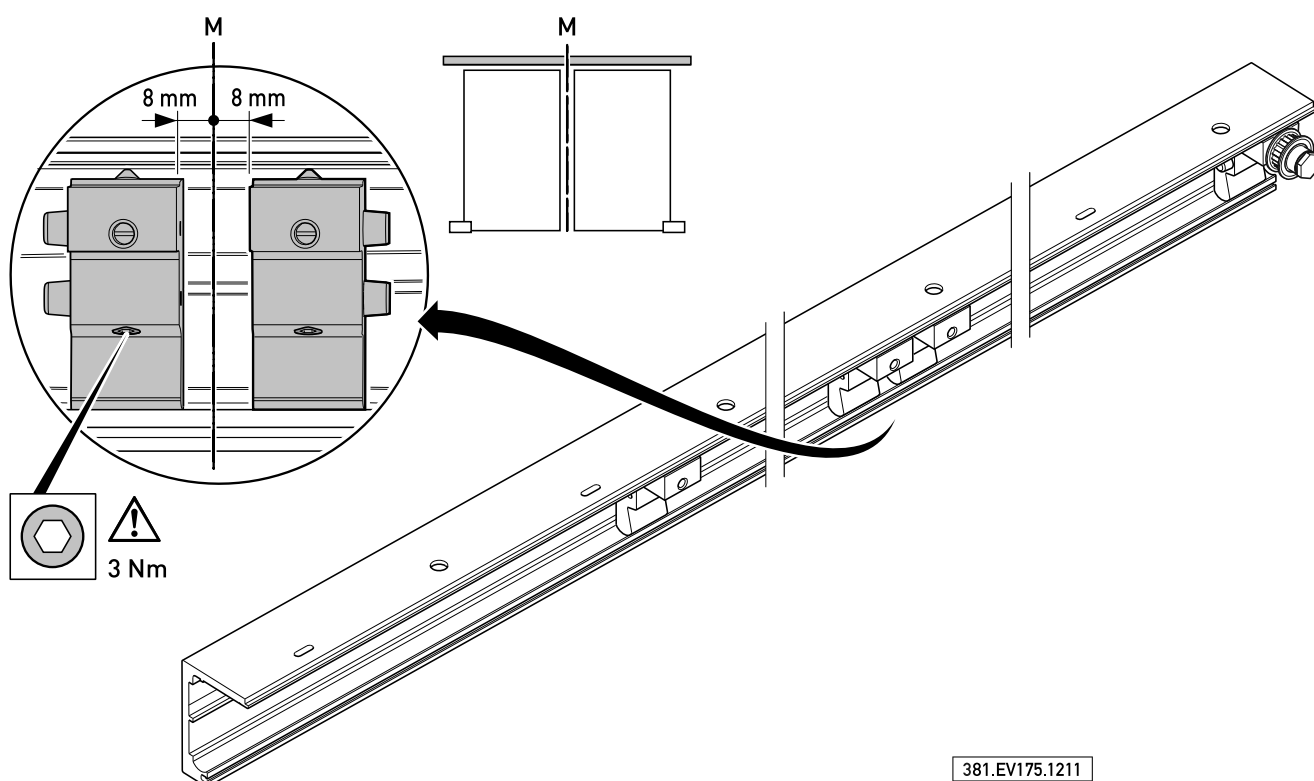

381.EV175.1211



Installation of the side-light

Installation of profiles

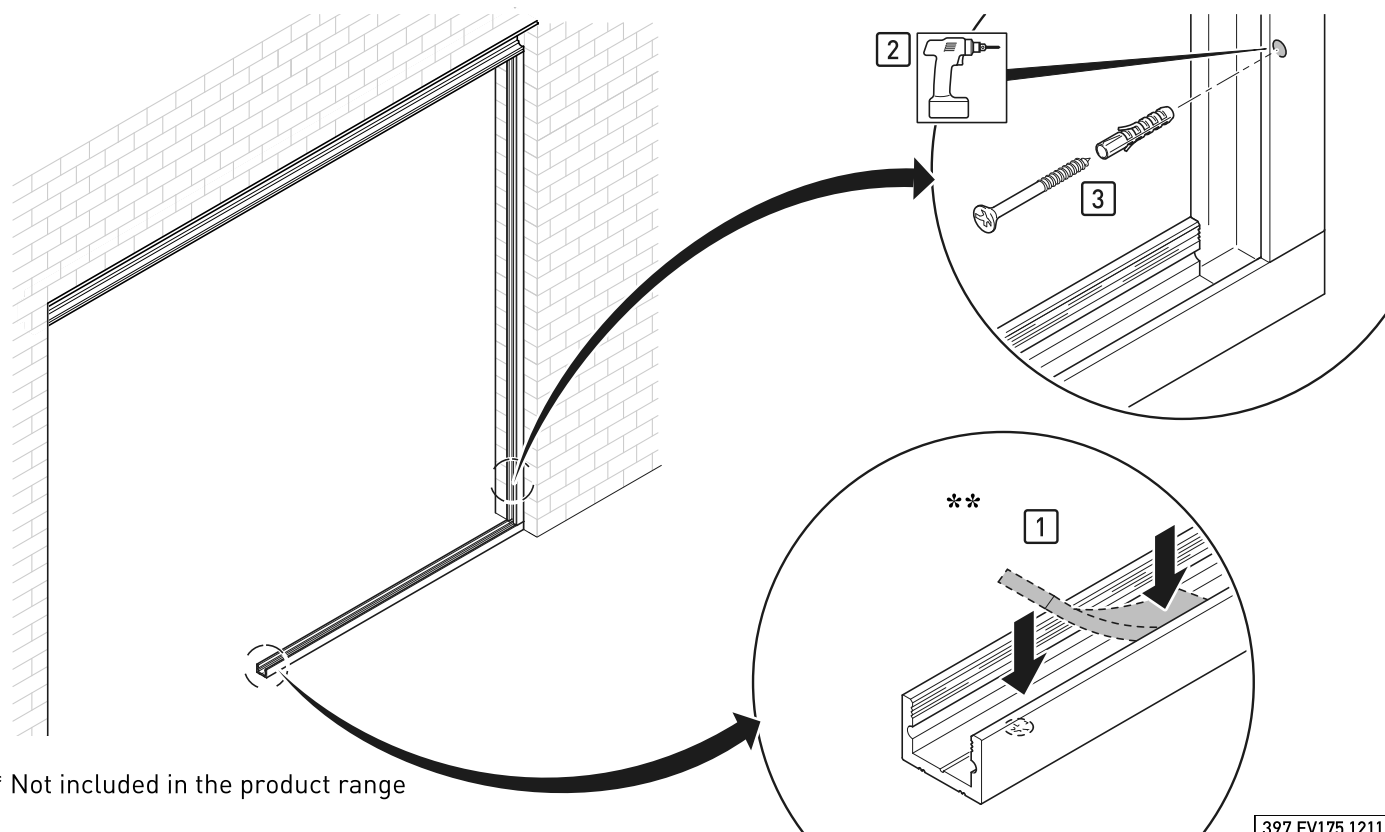

** Not included in the product range

397.EV175.1211

Silicone strip for track profile

Sash	Order number		
	transparent	black	
10 mm	617 254.0000.000	617 254.0000.090	
12 mm	617 256.0000.000	617 256.0000.090	

Silicone strip for U-profile

Sash	Order number		
	transparent	black	
10 mm	617 255.0000.000	617 255.0000.090	
12 mm	617 256.0000.000	617 256.0000.090	



vitris

Installation of the side-light

Insert sash

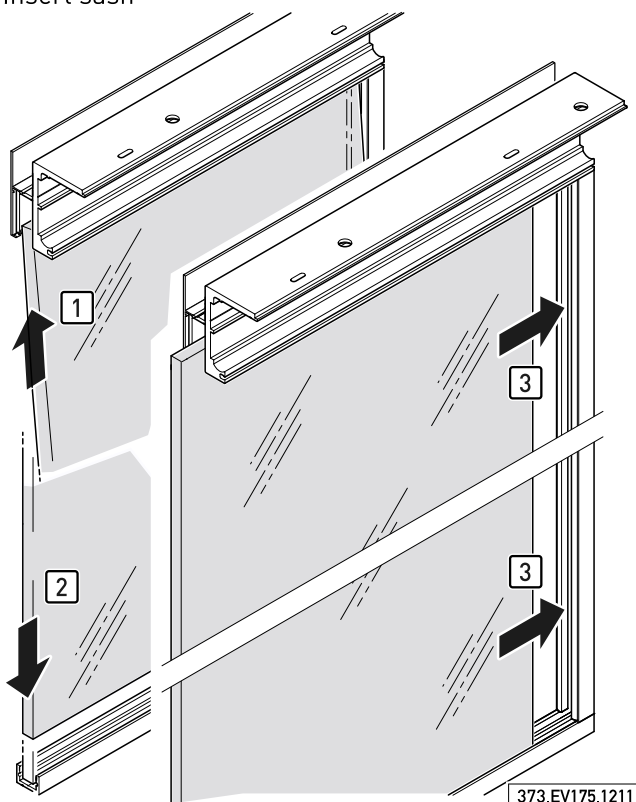

Insert silicon joint

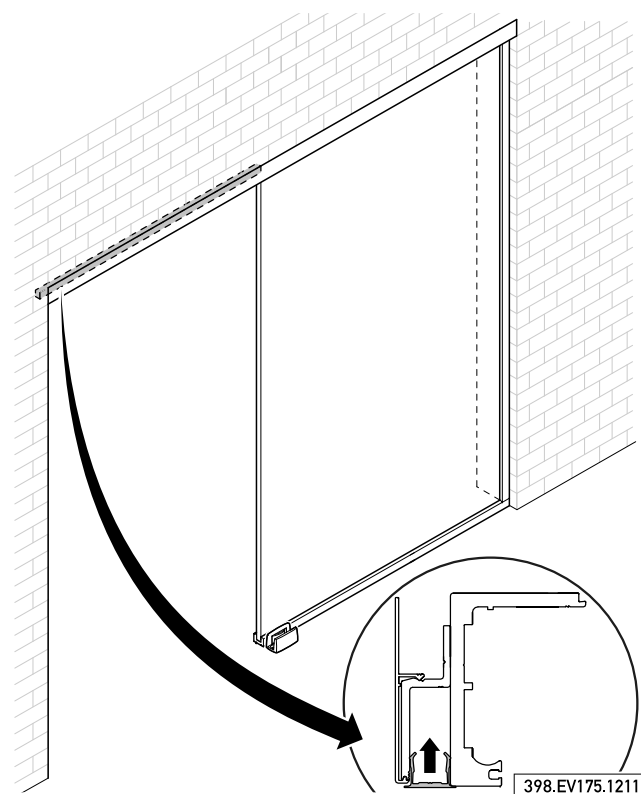
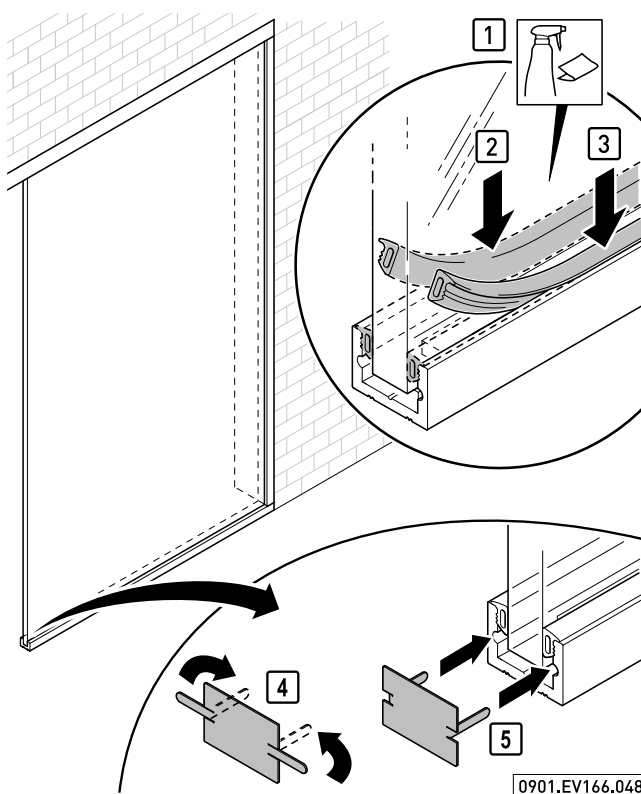
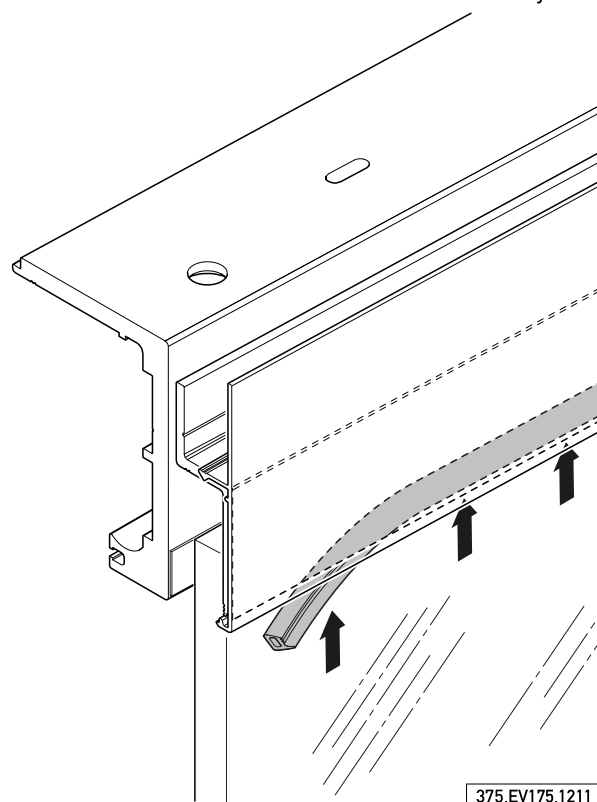



vitris

Door fittings

Choice of shims

⚠ Risk of injury if sash falls out because of improper assembly!

The clamp surfaces of the roller assemblies and shims must be clean, dry and free from grease.

- Clean sash and shims with glass cleaner and allow to dry.
- After cleaning, do not touch shims and roller assemblies on the clamping surfaces.

Choice of shims per assembly side

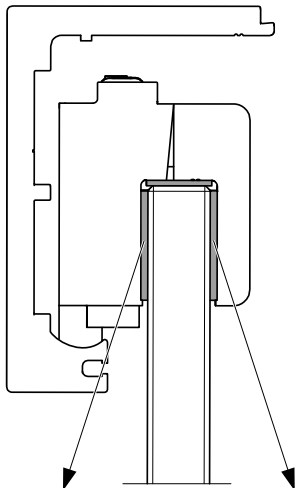
Toughened glass	Laminated safety glass		
		Left side	Right side
8 mm	8,76 mm	1 + 2 mm	1 + 2 mm
		1 + 2 mm	0,5 + 2 mm
10 mm	10,76 mm	2 mm	2 mm
		2 mm	0,5 + 1 mm
12 mm	12,76 mm	1 mm	1 mm
		1 mm	0,5 mm

Portavant 80 - instrucțiuni de montaj

Uși glisante din sticlă acționate electronic



ACCESORIA GROUP

House of innovation

vitris

Cleaning

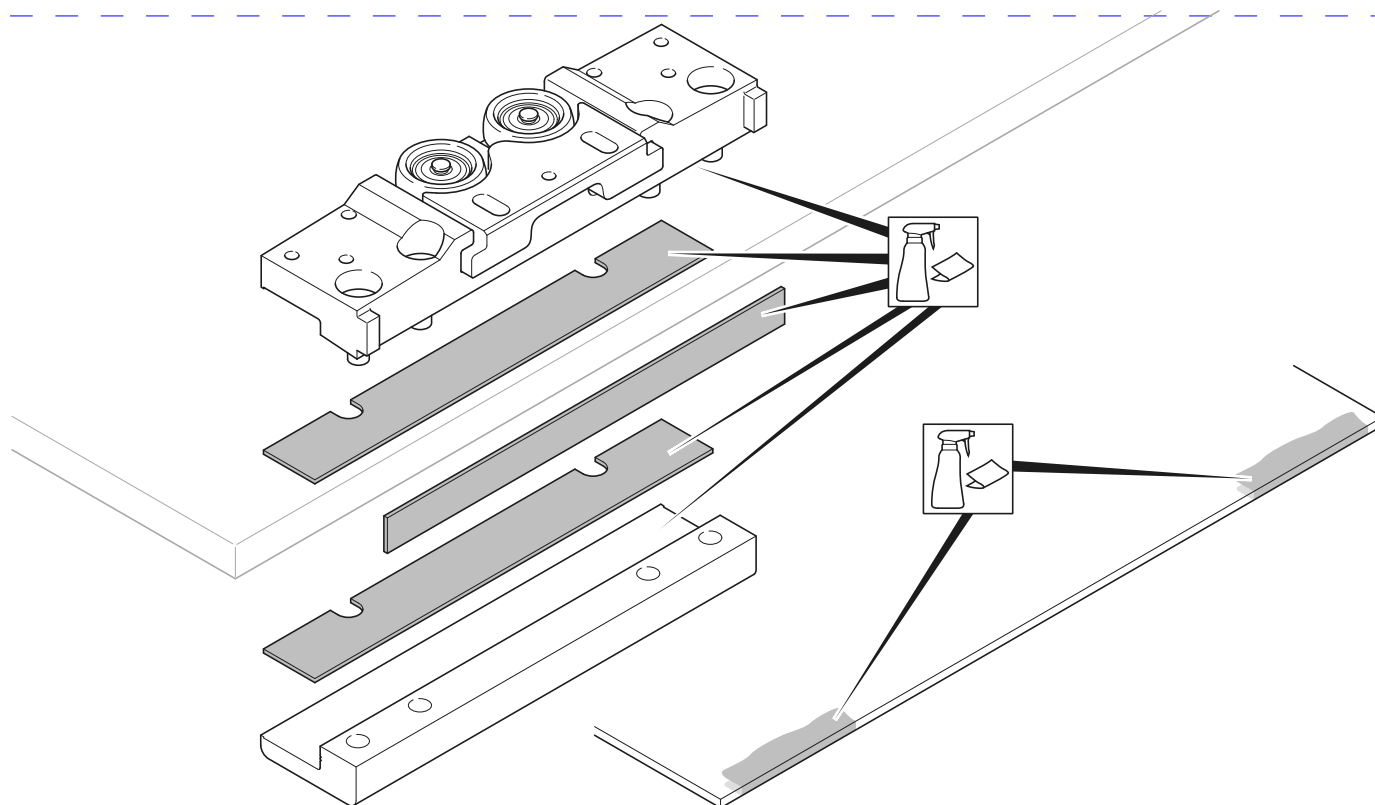

0910.EV166.013



vitris

Door fittings

Assembly of roller assemblies

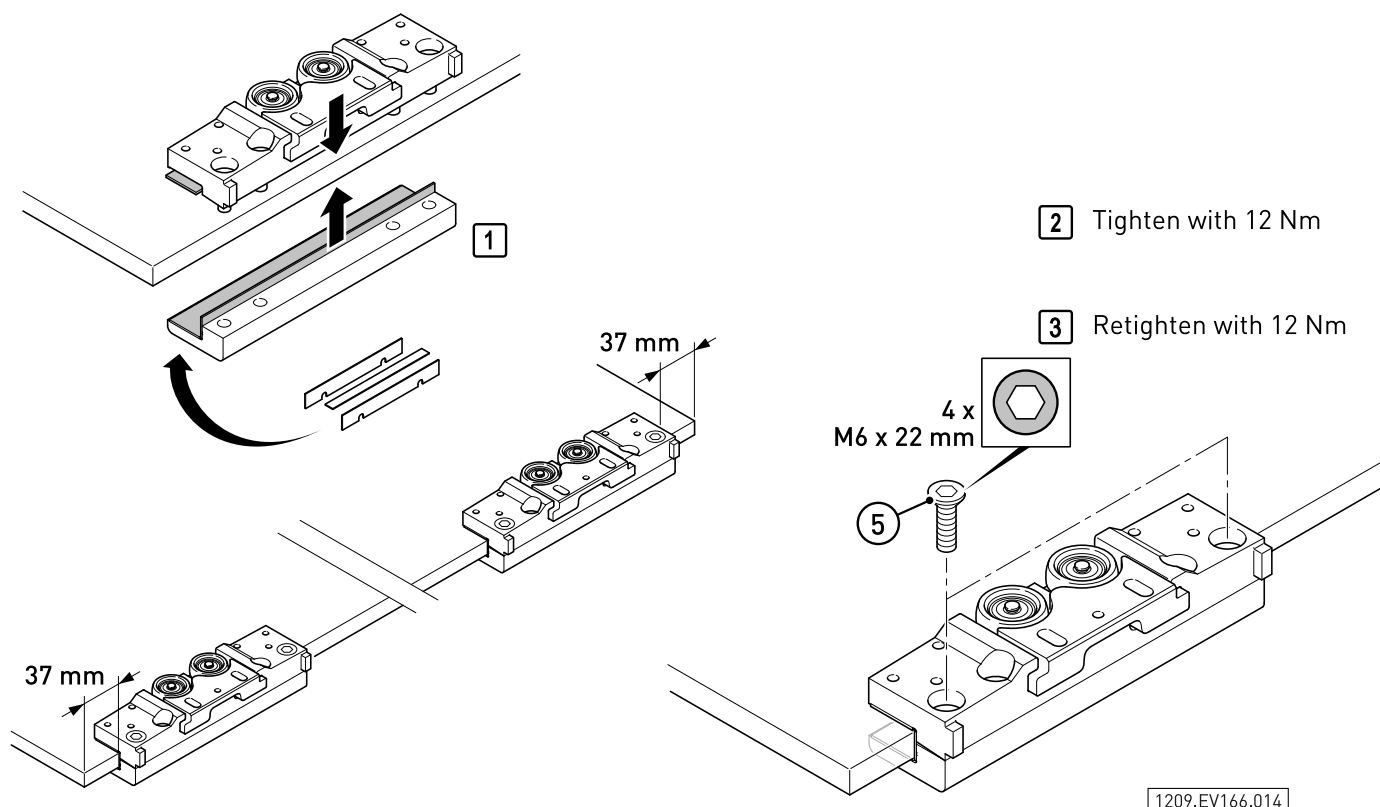

Mounting the belt bracket

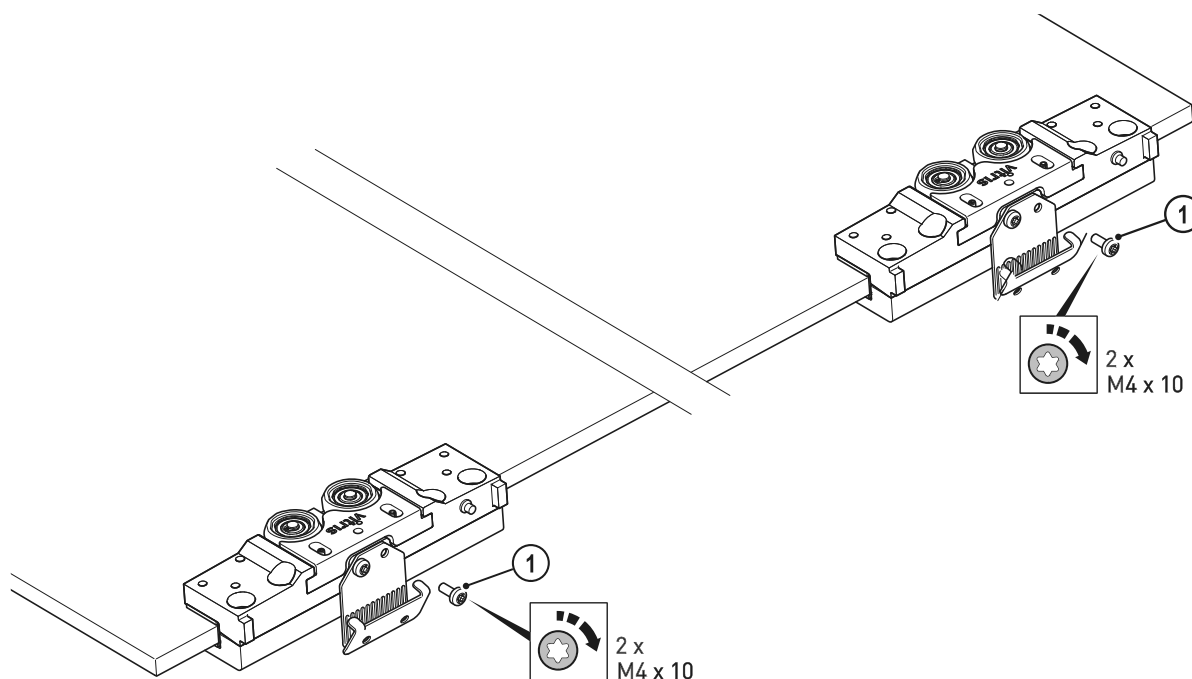

315.EV175.1211



vitris

Assembly

Belt bracket on double sash door

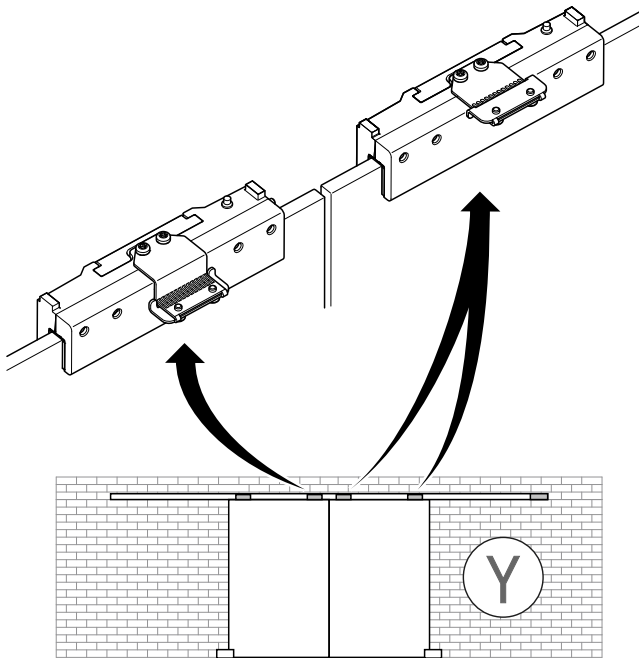

379.EV175.1209

Suspending sliding door



Risk of injury!

- Without safety catch, the glass sliding door may jump out of the track profile.

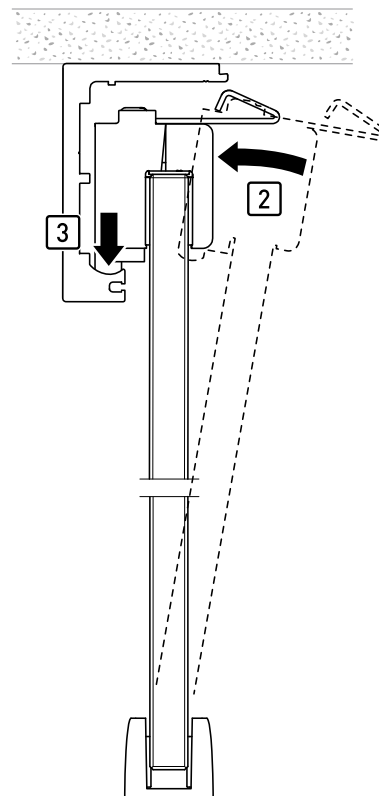
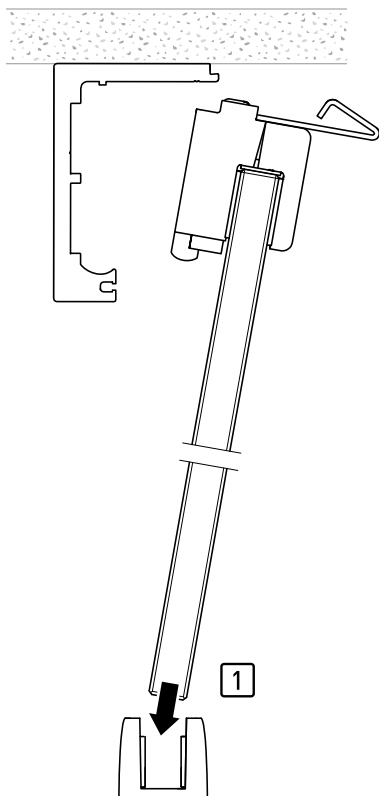

316.EV175.1207



vitris

Adjustments

Height adjustment

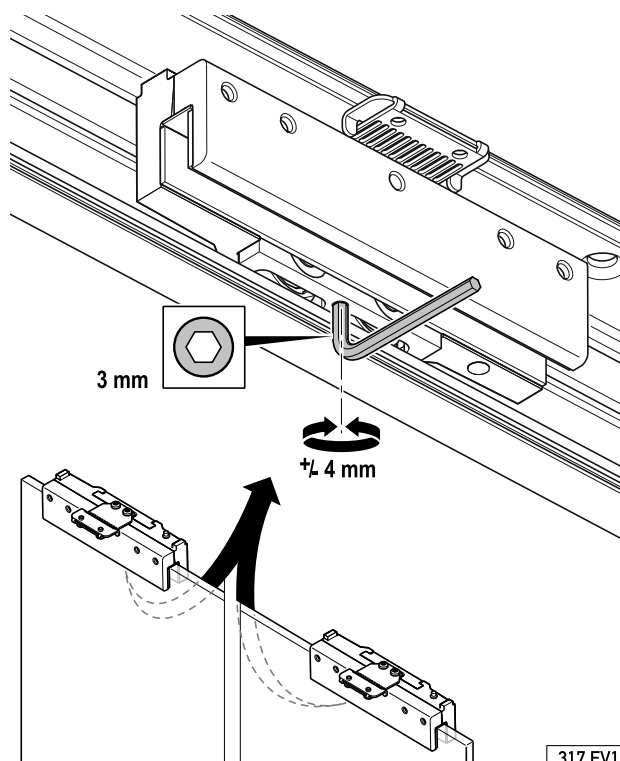

317.EV175.1207



Danger!

The glass sliding door may jump out of the top track if there is no safety catch.

- Adjust the safety catch as described below.

Adjustment of the safety catch

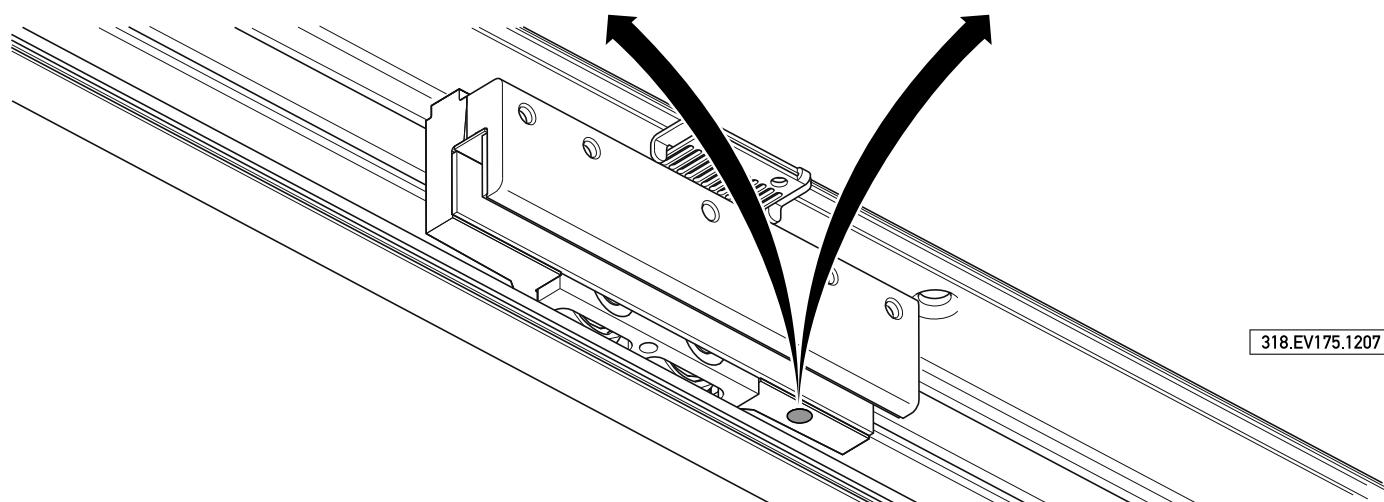
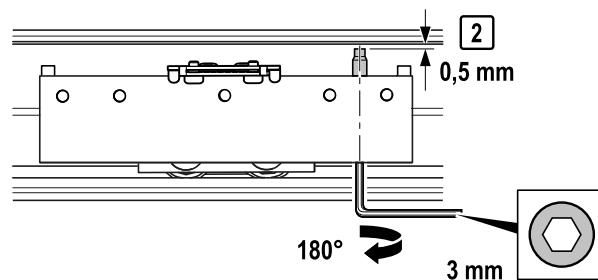
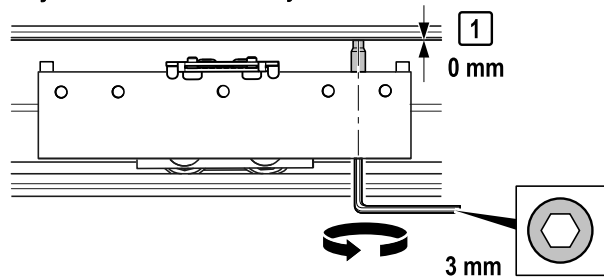

318.EV175.1207



vitris

Adjustments

Height adjustment

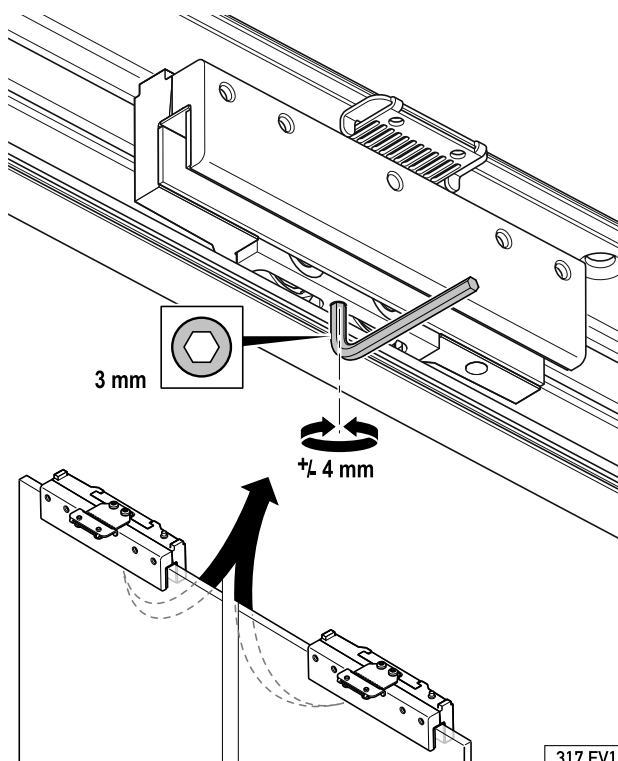

317.EV175.1207



Danger!

The glass sliding door may jump out of the top track if there is no safety catch.

- Adjust the safety catch as described below.

Adjustment of the safety catch

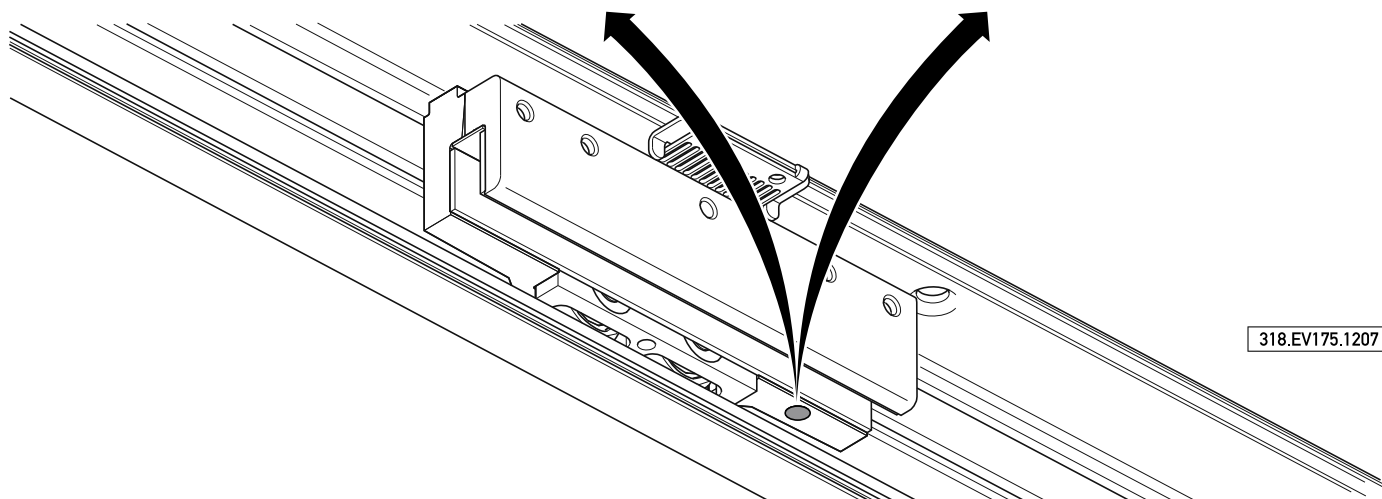
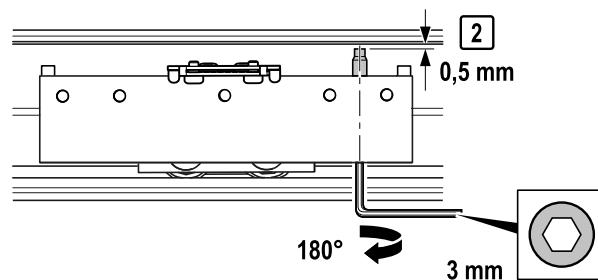
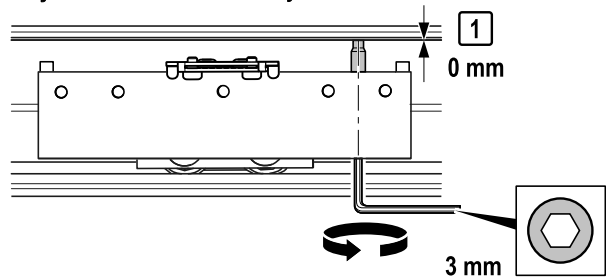

318.EV175.1207



Assembly of the drive

Preparation of drive

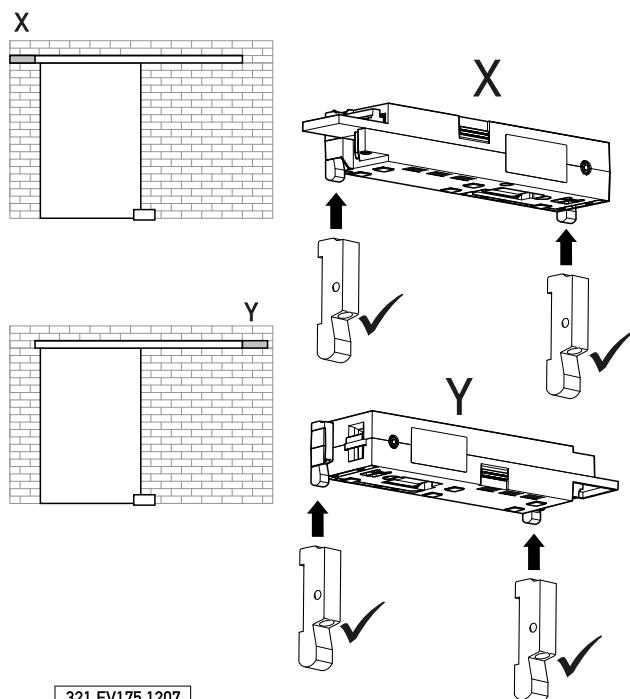

Drive on the left side

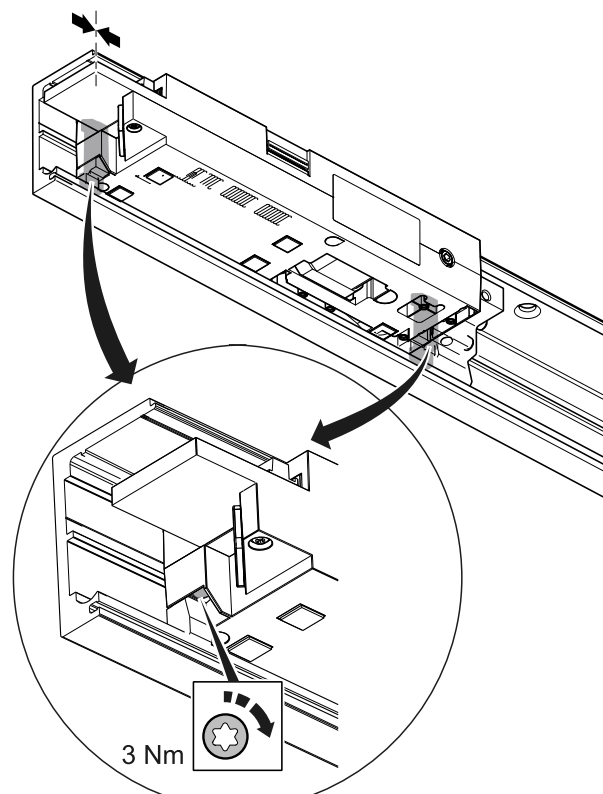

Drive on the right side

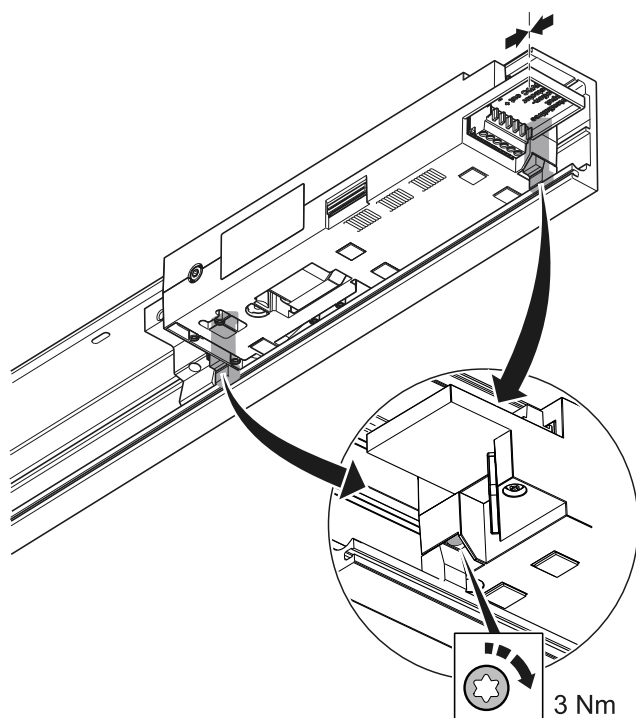



Assembly of the belt: 1 sash

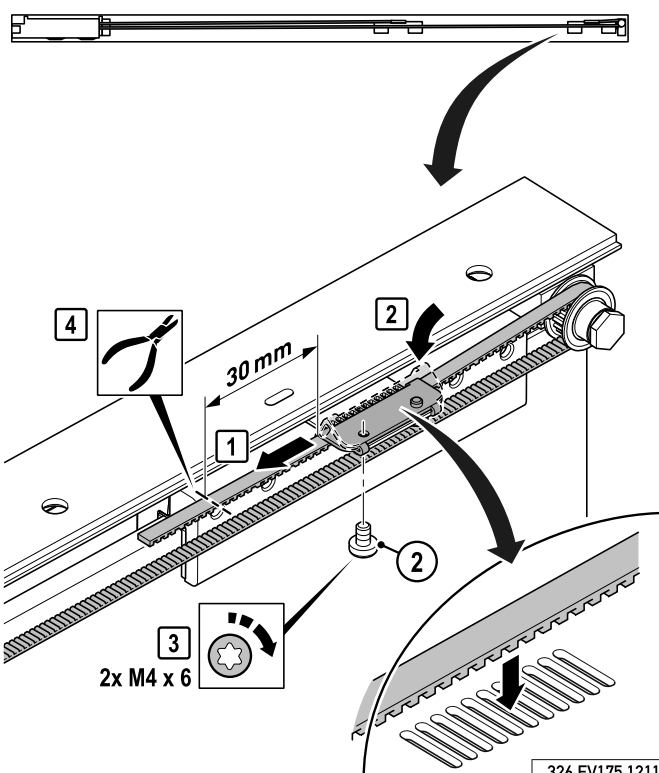
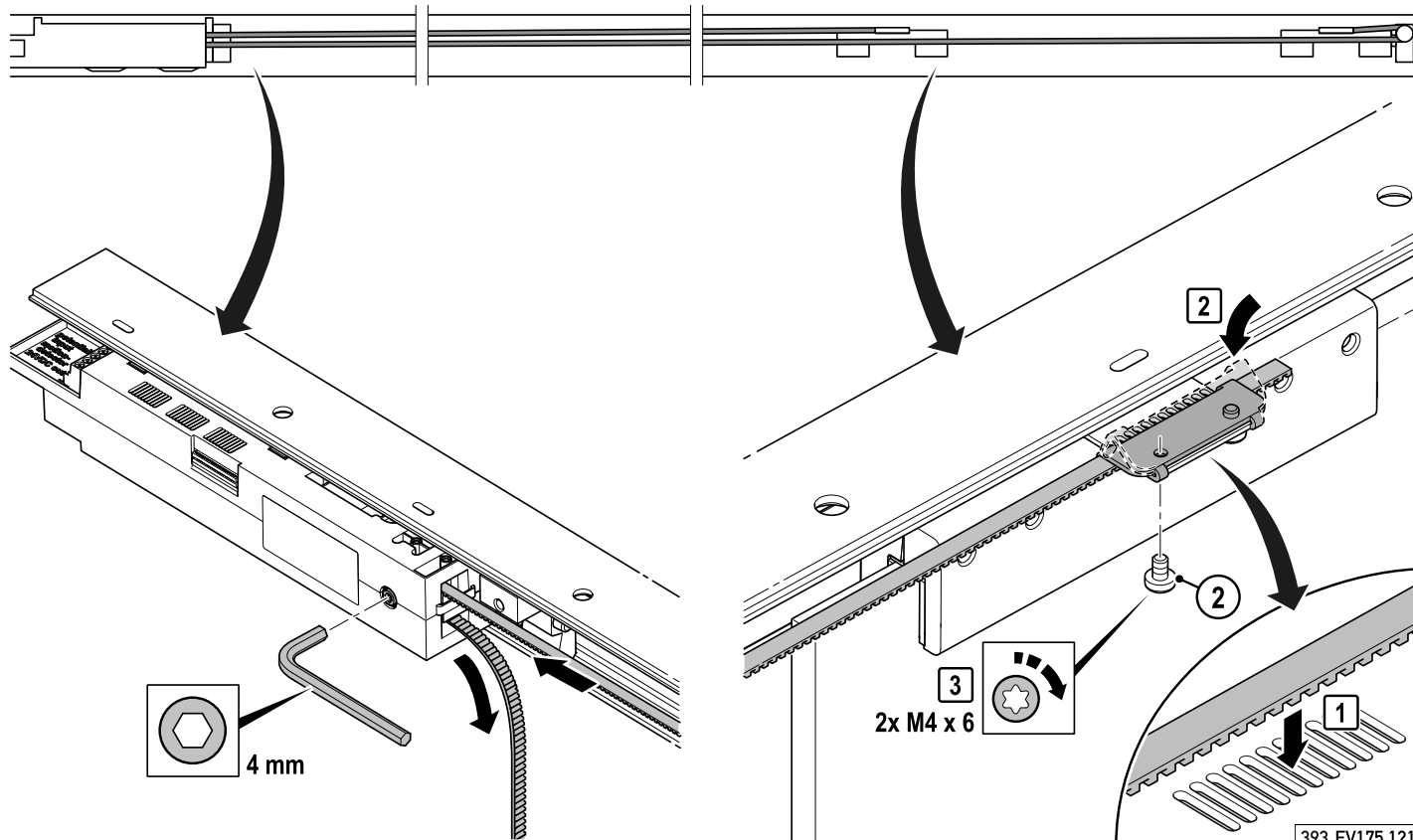

i Note:
Excessive belt tension will cause premature wear of the drive system.
Slack of the belt will cause the door judder.

- Tension the belt by hand when installing it.
- Cut off the protruding end.



vitris

Assembly of the belt

2. 2nd sash

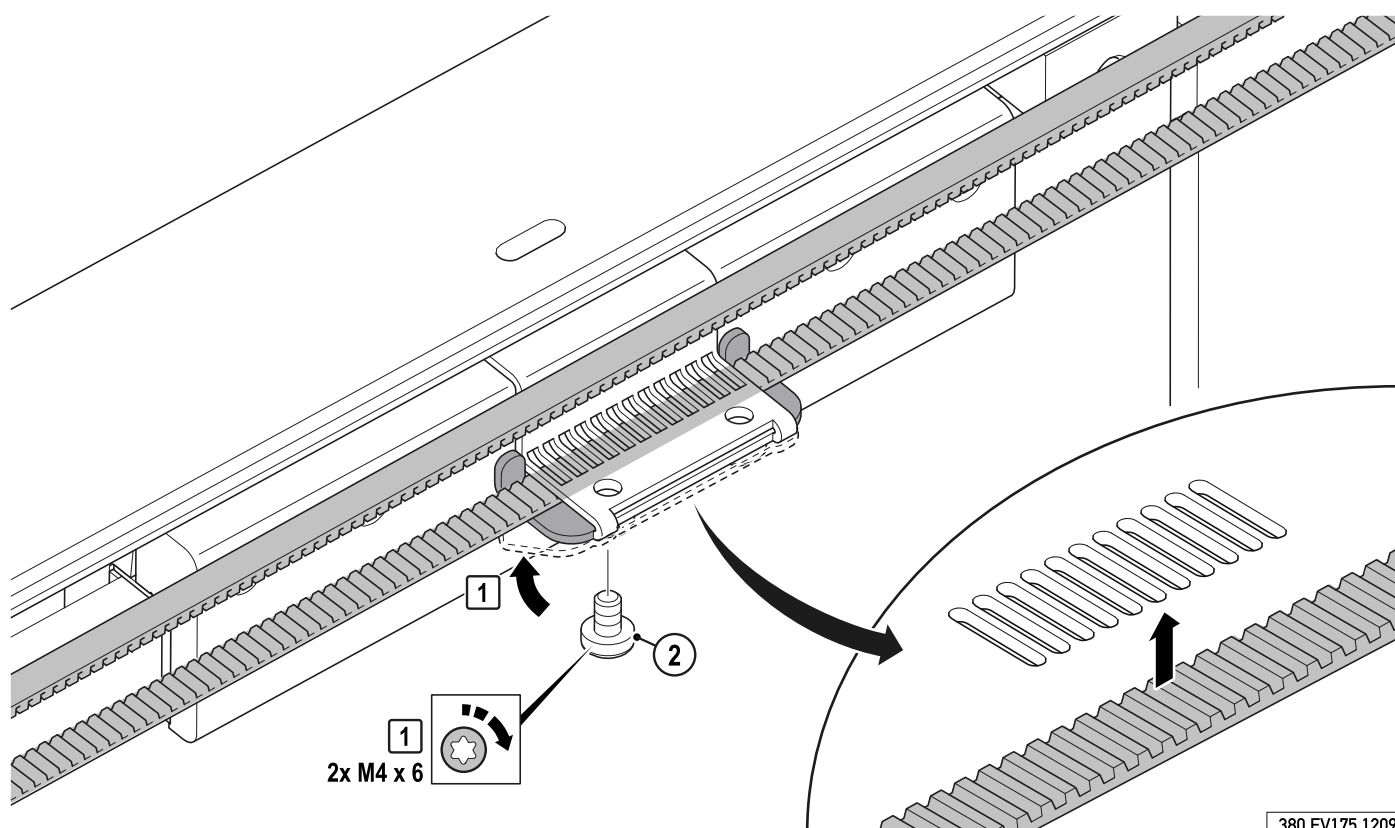

Note:

Excessive belt tension will cause premature wear of the drive system.

Slack of the belt will cause the door judder.

- Tension the belt by hand when installing it.
- Cut off the protruding end



vitris

Assembly of the control unit

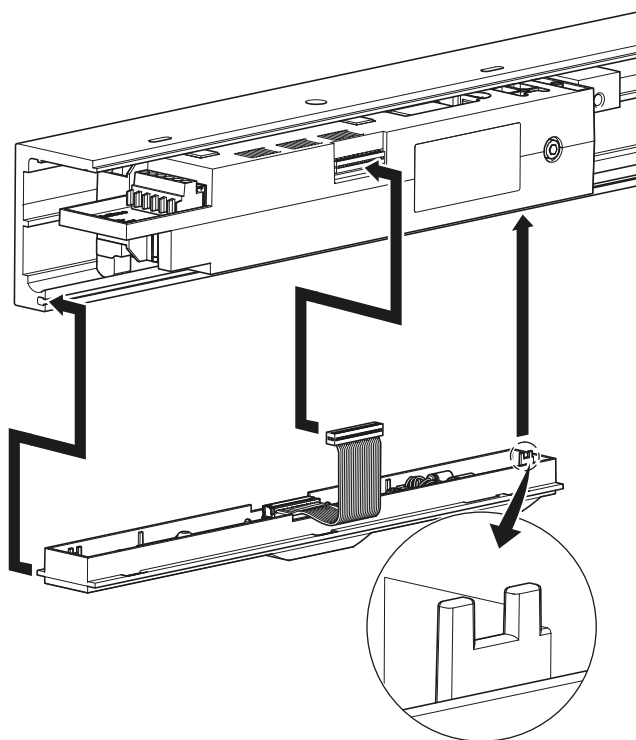

Caution!

Twisting the ribbon cable will damage it.

- Ensure that the cable lies flat on the drive unit housing when connecting it

327.EV175.1207



vitris

Final assembly

Assembly of cover profile

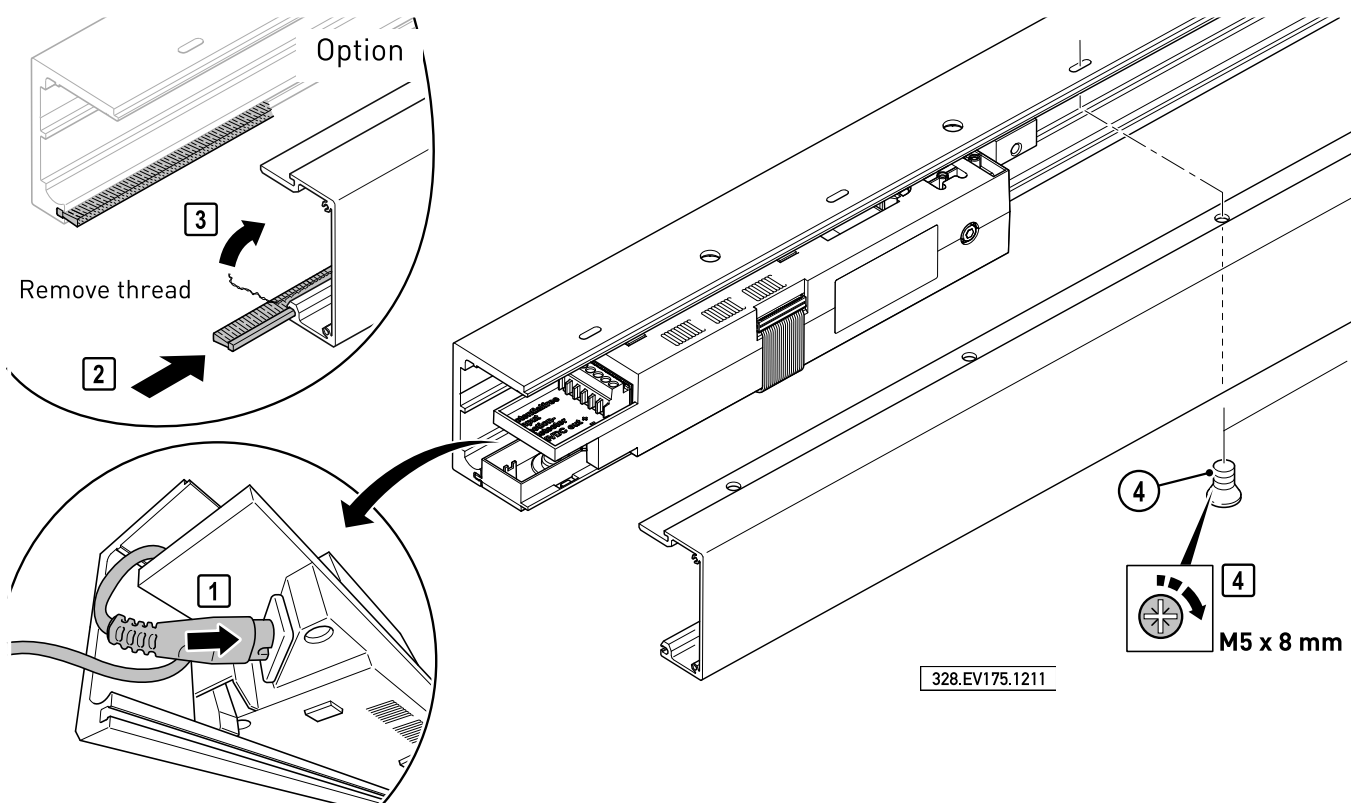

Risk of injury!

- Insert screw into each drill hole and tighten.

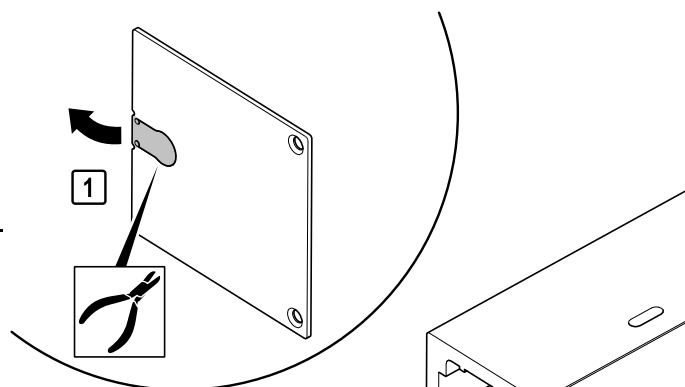

Assembly of end-plates



Note: sharp edge!

- Use a conduit to prevent damage to the ribbon cable.



Starting up

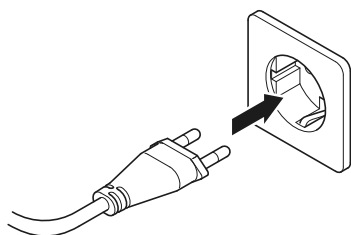
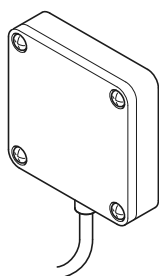
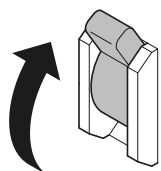

333.EV175.1207

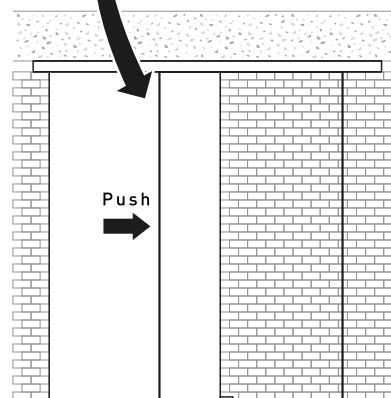
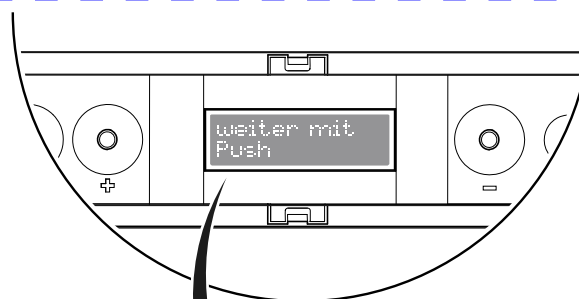

394.EV175.1211

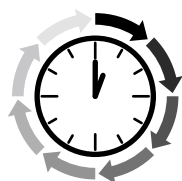
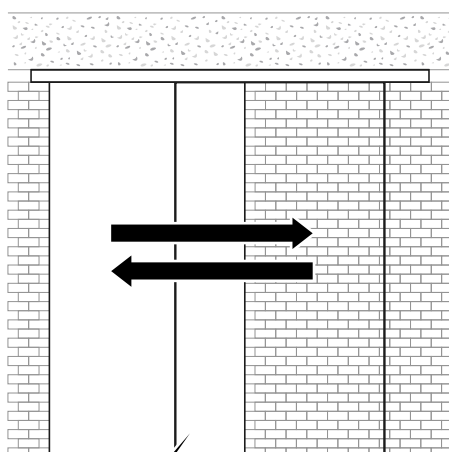

- Wait for teach-in cycle to complete.
- Adjust the basic settings as outlined on the following page.

344.EV175.1211



vitris

Settings

Menu structure

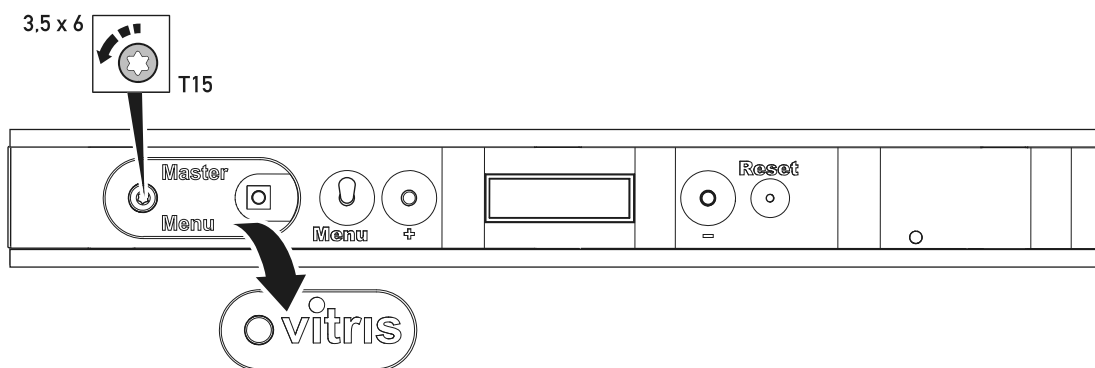

342.EV175.1211

User guidance

- Press a menu key to select a menu.
- Press plus or minus key repeatedly to select the setting.
- Press the corresponding menu key to confirm the current setting. The system then changes to the subsequent menu item.

Door mass



Risk of injury!

- The mass of the door affects its speed.
 - Never select a mass that is too low.
 - In case of double-sash doors, a value rated "2x" must be selected.
- Observe the safety instructions in the manual in section 2, 6 and 7.

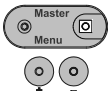
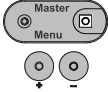
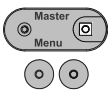
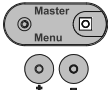
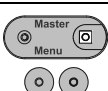

Settings

 Master Menu			
Menu	Key sequence	Display	
1 Language selection		Language	
		English, Deutsch, Español, Français, Italiano	
2 Set door position		Closing direction	
		right/left	
3 Set door mass		Door mass	Siehe Benutzerhandbuch. See user manual. Voir le manuel d'utilisation.
		1x20kg, 1x30kg, 1x40kg, 1x50kg, 1x60kg, 1x70kg, 1x80kg, 2x20kg, 2x30kg, 2x40kg, 2x50kg, 2x60kg	
4 Option: Connect radio receiver		Radio receiver	Siehe Montageanleitung Funkzubehör. See assembly instructions for radio-control accessories. Voir la notice de montage du récepteur radioélectrique.
		connect	
5 Disable the user menu		User menu	Siehe Benutzerhandbuch. See user manual. Voir le manuel d'utilisation.
		enabled, disabled	



vitris

Function check

with default settings

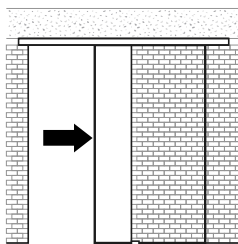

- Push-start the door.

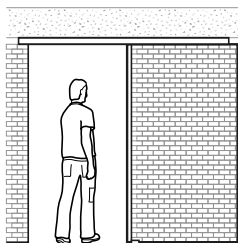

Door opens automatically.

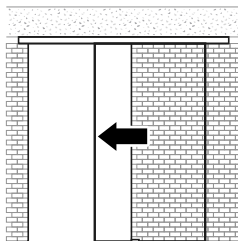

Door closes automatically after its opening period has elapsed.

351.EV175.1211

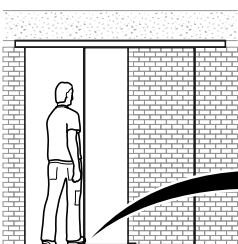

- Block the door.

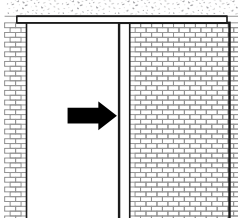
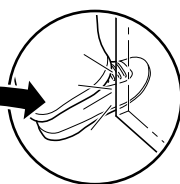

Door reverses and opens automatically.

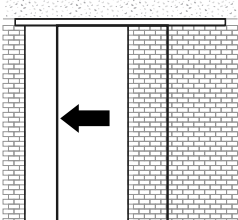

Door closes automatically after its opening period has elapsed.

352.EV175.1211



vitris

Motion detector (accessory)

Mounting the motion detector



Note:

- Observe the information provided in the original instructions supplied by the motion detector manufacturer.

The motion detector can be mounted onto the cover profile.

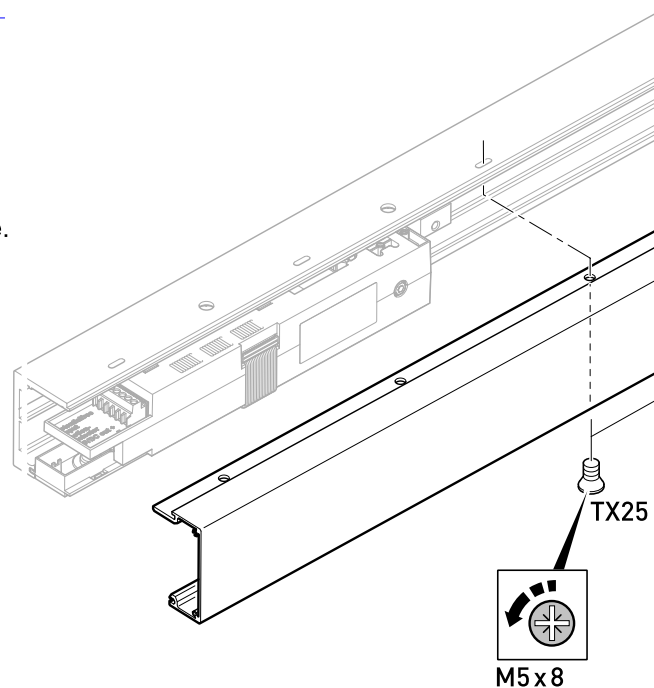

411.EV175.1301

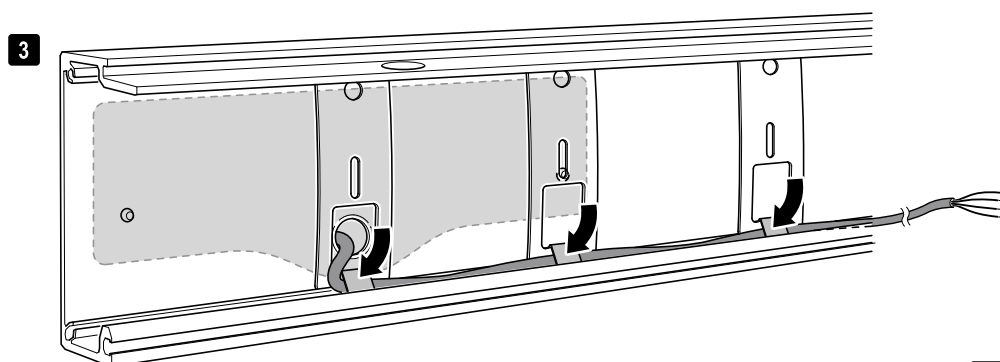
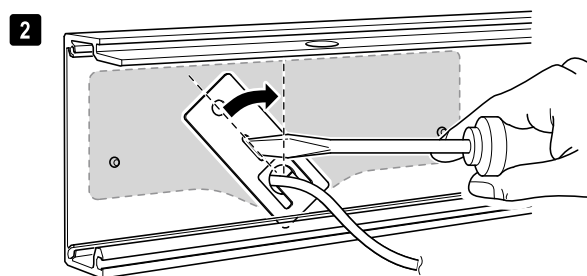
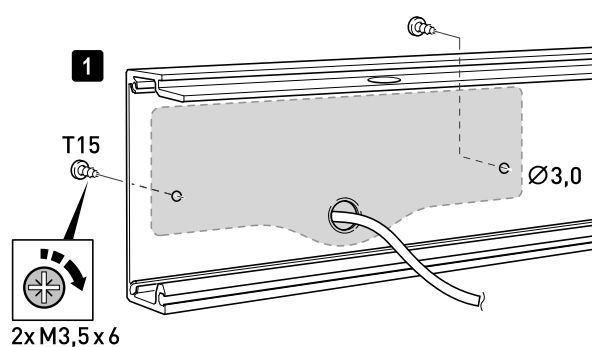

412.EV175.1301



vitris

Motion detector (accessory)

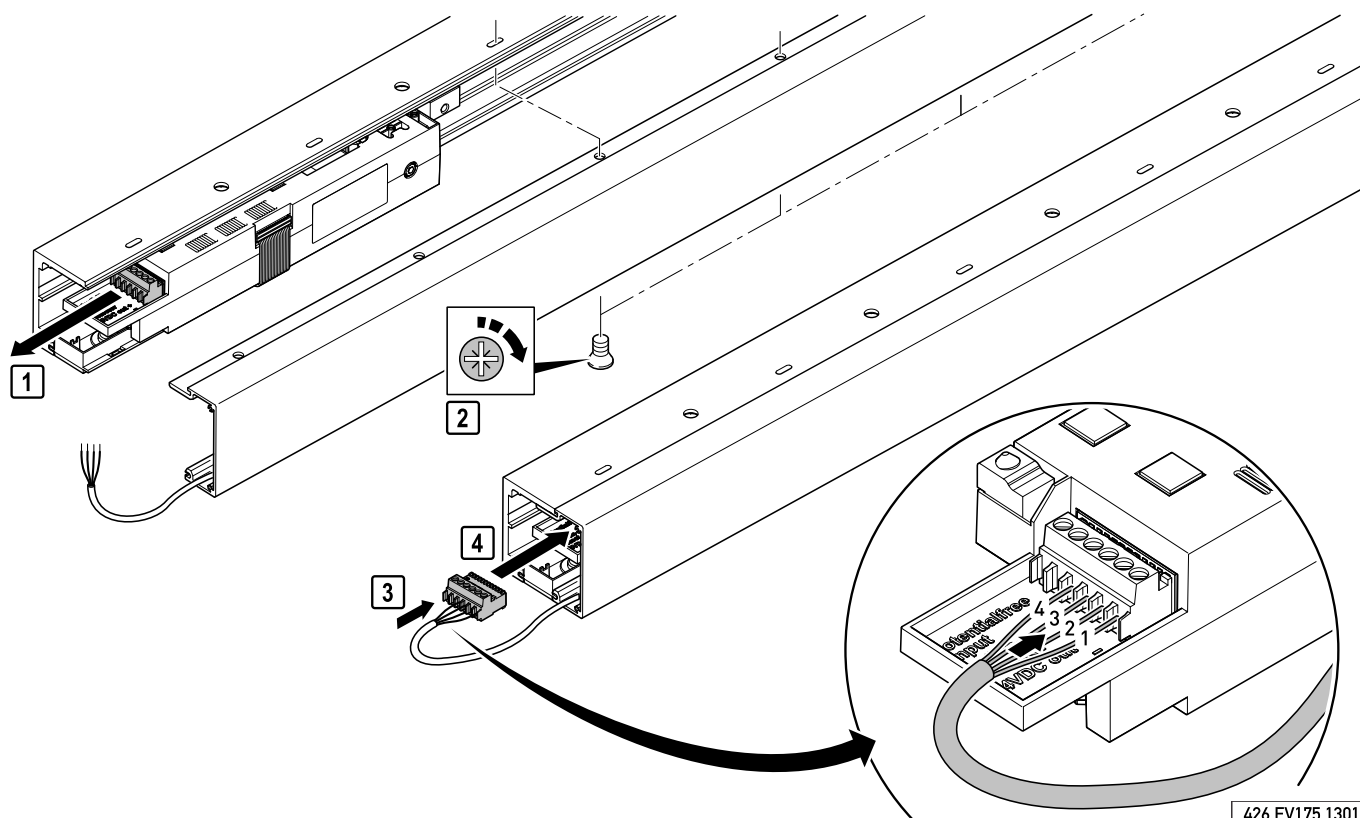

426.EV175.1301

Nr./No.	Colour
1	black
2	white
3	brown
4	blue



vitris

Radio remote-control (accessory)

Installing the radio receiver



Danger!

Radio transmitters may cause interferences with medical equipment and may e.g. not be used in hospitals.

- Be sure to observe the information provided in the original instructions supplied by the radio transmitter manufacturer.

Caution when unpacking the circuit board!

Risk of damage by electrostatic discharge.

- Observe the guidelines concerning electrostatic discharge.

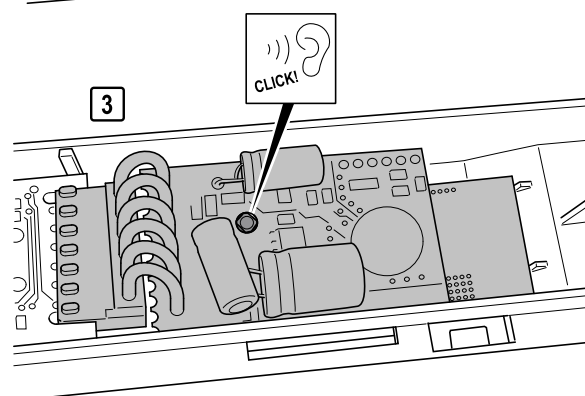
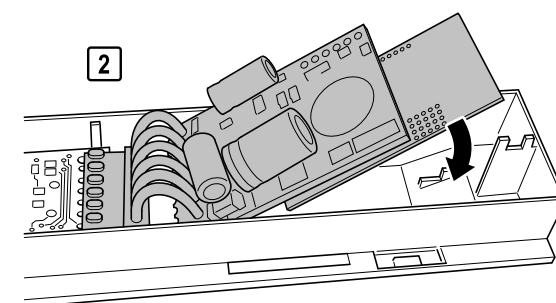
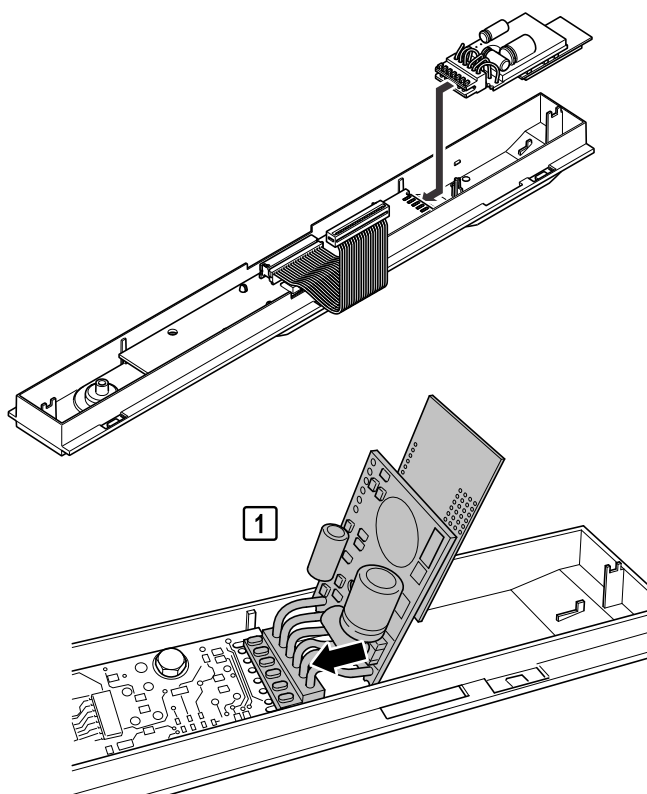

409.EV175.1301



Radio remote-control (accessory)

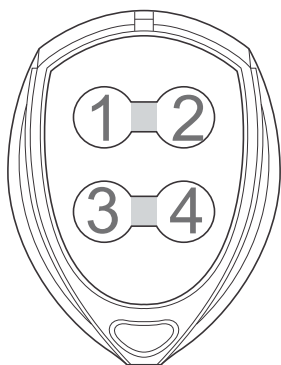

We recommend to initially set the radio transmitter to 4-channel mode:

- Press and hold key 2 and 3 simultaneously for 5 seconds.

410.EV175.1301

Teaching-in the radio transmitter

3,5 x 6

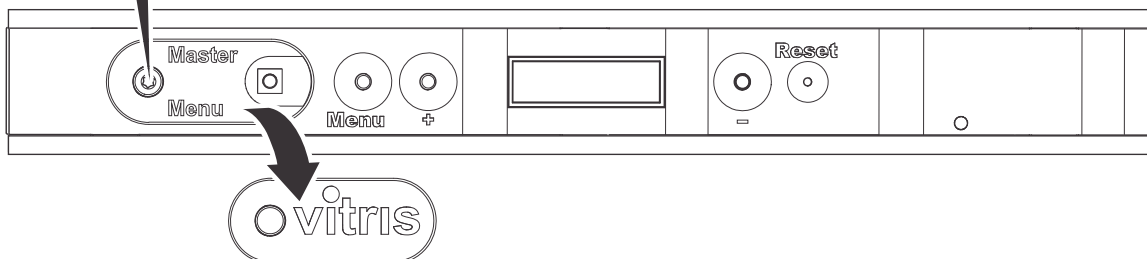

342.EV175.1302

Master Menu	
Key sequence	Display
	<p>Radio receiver connect</p> <p>Press the respective key at the at the radio transmitter for the desired channel allocation.</p>